

AENC-TQST-LAN-DWG-0002

Norwich to Tilbury

Volume 2: Plans, Drawings and Sections

Document: 2.2 Land Plans - Section C

Revision B

October 2025

Planning Inspectorate Reference: EN020027

Infrastructure Planning (Applications: Prescribed Forms and Procedure)
Regulations 2009 Regulation 5(2)(i)(i)-(iii)

nationalgrid

LAND PLANS KEY PLAN

REGULATION 5(2)(i)(i)-(iii)

SECTION C (SHEET 1 OF 1,
MID SUFFOLK DISTRICT COUNCIL, BABERGH DISTRICT COUNCIL, TENDRING DISTRICT COUNCIL AND COLCHESTER CITY COUNCIL)

SITE MAP

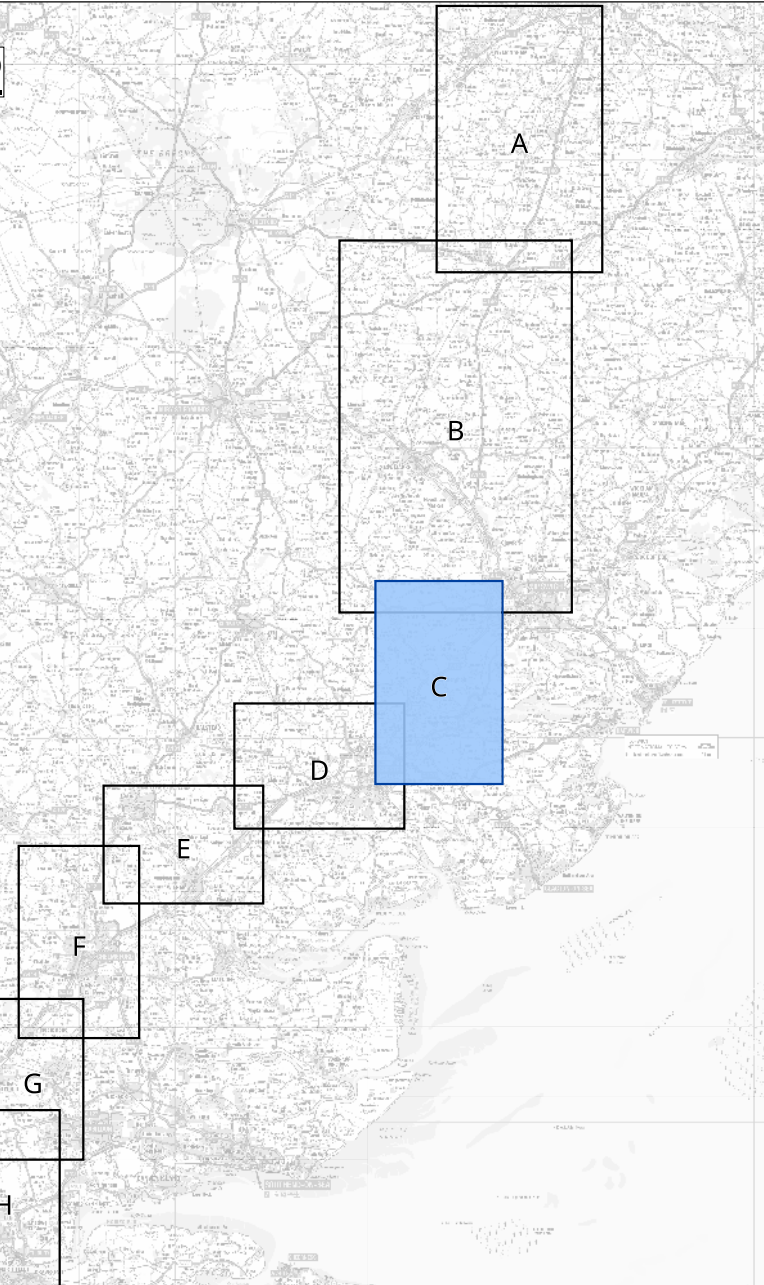

Legend

- Local authority boundary
- Section boundary & local authority boundary
- ... Section boundary
- Sheet index
- Order Limits

Notes

1. For additional detail on the plan suites, please refer to the Guide to Plans (document reference 2.0), located in the Volume 2 of the DCO application.
2. This drawing is scaled at paper size A0, therefore any prints taken at smaller sizes will affect accuracy of the measurement units and should not be scaled against.

Coordinate System: British National Grid

Sheet X Centroid Coordinate : 607373

Sheet Y Centroid Coordinate : 235778



BACKGROUND MAPPING INFORMATION HAS BEEN REPRODUCED FROM THE ORDNANCE SURVEY BY PERMISSION OF ORDNANCE SURVEY OF THE CONTROLLER OF HIS MAJESTY'S STATIONERY OFFICE. © CROWN COPYRIGHT AND DATABASE RIGHTS(2025) LICENCE OS100024241 AND AC0000807948.

B	OCT-2025	October 2025 Update	CLJ	AMI	CLJ
A	AUG-2025	For DCO Submission	CLJ	KPA	TPR
Issue	Date	Remarks	Drawn	Checked	Approved

Title:

THE NATIONAL GRID
(NORWICH TO TILBURY) ORDER
LAND PLANS KEY PLAN
REGULATION 5(2)(i)-(iii)
SECTION C (SHEET 1 OF 1
IID SUFFOLK DISTRICT COUNCIL,
BABERGH DISTRICT COUNCIL,
ENDRING DISTRICT COUNCIL AND
COLCHESTER CITY COUNCIL)

nationalgrid

PINS Application Number

EN020027

National Grid Drawing Reference

AENC-TQST-LAN-DWG-0002

Scale

1:19,00

Sheet 9

A

Sheet

SHEE

sue

B

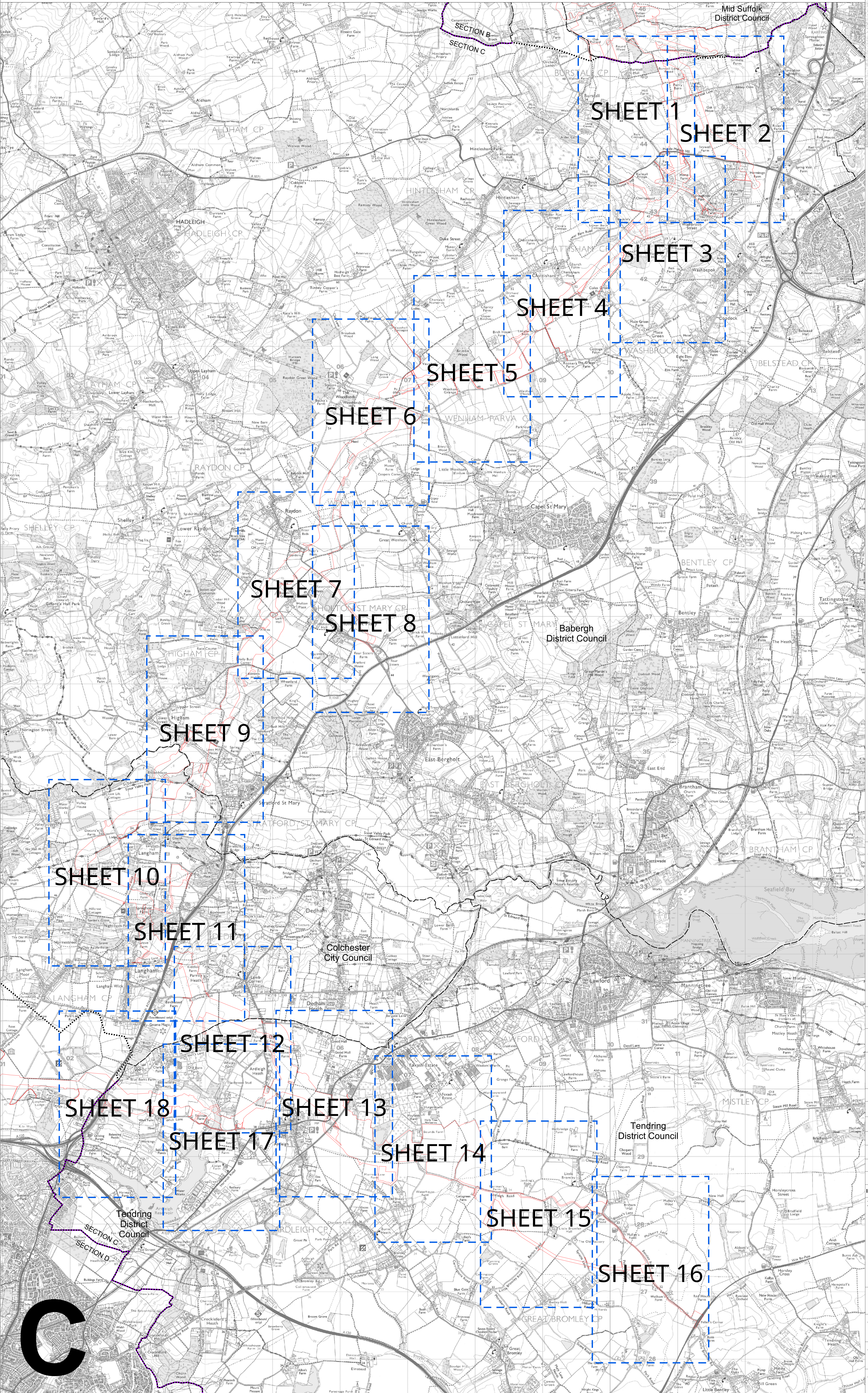

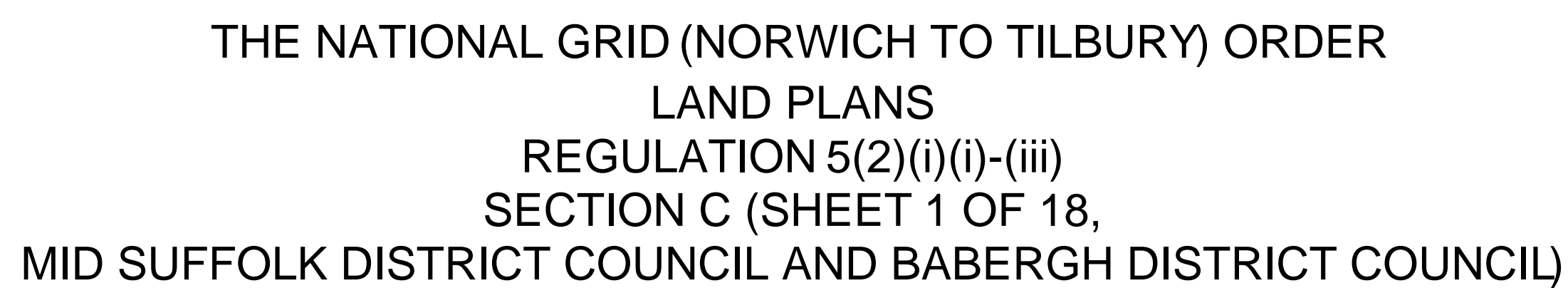

- Local authority boundary
- Section boundary & local authority boundary
- Section boundary
- Sheet index cutlines
- Order Limits
- Class 1 - Compulsory acquisition of land
- Class 2 - Compulsory acquisition of rights - Overhead line
- Class 3 - Compulsory acquisition of rights - Underground cable system
- Class 4 - Compulsory acquisition of rights - Overhead line and underground cable system
- Class 5 - Compulsory acquisition of rights - Access
- Class 6 - Compulsory acquisition of rights - Drainage
- Class 7 - Temporary use
- Class 8 - Land not subject to powers of acquisition nor temporary use

1. For additional detail on the plan suites, please refer to the Guide to Plans (document reference 2.0), located in the Volume 2 of the DCO application.
2. This drawing is scaled at paper size A0, therefore any prints taken at smaller sizes will affect accuracy of the measurement units and should not be scaled against.

A horizontal scale bar with markings at 0, 50, 100, 150, 200, and 250. The unit 'Metres' is written at the right end.

B	OCT-2025	October 2025 Update	BBU	AMI	CLJ
A	AUG-2025	For DCO submission	BBU	AMI	CLJ
Issue	Date	Remarks	Drawn	Checked	Approved

THE NATIONAL GRID
(NORWICH TO TILBURY) ORDER
LAND PLANS
REGULATION 5(2)(i)-(iii)
SECTION C (SHEET 1 OF 18
MID SUFFOLK DISTRICT COUNCIL
AND BABERGH DISTRICT COUNCIL)

<u>PINS Application Number</u>	EN020027
--------------------------------	----------

National Grid Drawing Reference

AENC-TQST-LAN-DWG-0002

<u>Scale</u>	<u>Sheet Size</u>	<u>Sheet</u>	<u>Issue</u>
1:2,500	A0	SHEET 1 of 18	B

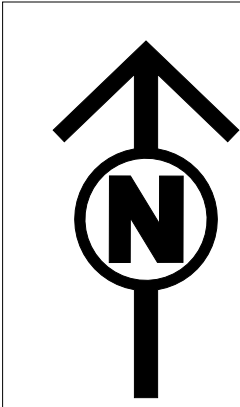

THE NATIONAL GRID (NORWICH TO TILBURY) ORDER
LAND PLANS
REGULATION 5(2)(i)-(iii)
SECTION C (SHEET 2 OF 18,
MID SUFFOLK DISTRICT COUNCIL AND BABERGH DISTRICT COUNCIL)

Application Document 2.2

SITE MAP

C

Legend

- Local authority boundary
- Section boundary & local authority boundary
- Section boundary
- Sheet index cutlines
- Order Limits
- Class 1 - Compulsory acquisition of land
- Class 2 - Compulsory acquisition of rights - Overhead line
- Class 3 - Compulsory acquisition of rights - Underground cable system
- Class 4 - Compulsory acquisition of rights - Overhead line and underground cable system
- Class 5 - Compulsory acquisition of rights - Access
- Class 6 - Compulsory acquisition of rights - Drainage
- Class 7 - Temporary use
- Class 8 - Land not subject to powers of acquisition nor temporary use

Notes

- For additional detail on the plan suites, please refer to the Guide to Plans (document reference 2.0), located in the Volume 2 of the DCO application.
- This drawing is scaled at paper size A0, therefore any prints taken at smaller sizes will affect accuracy of the measurement units and should not be scaled against.

Coordinate System: British National Grid
Sheet X Centroid Coordinate: 611711 Sheet Y Centroid Coordinate: 244216

0 50 100 150 200 250 Metres

BACKGROUND MAPPING INFORMATION HAS BEEN REPRODUCED FROM THE ORDNANCE SURVEY BY PERMISSION OF ORDNANCE SURVEY OF THE CONTROLLER OF HIS MAJESTY'S STATIONERY OFFICE. © CROWN COPYRIGHT AND DATABASE RIGHTS (2025) LICENCE OS100024241 AND AC000807946.

B	OCT-2025	October 2025 Update	BBU	AMI	CLJ
A	AUG-2025	For DCO submission	BBU	AMI	CLJ
Issue	Date	Remarks	Drawn	Checked	Approved
Title:					
THE NATIONAL GRID (NORWICH TO TILBURY) ORDER LAND PLANS REGULATION 5(2)(i)-(iii) SECTION C (SHEET 2 OF 18 MID SUFFOLK DISTRICT COUNCIL AND BABERGH DISTRICT COUNCIL)					

nationalgrid			
PINS Application Number			
EN020027			
National Grid Drawing Reference			
AENC-TQST-LAN-DWG-0002			
Scale	Sheet Size	Sheet	Issue
1:2,500	A0	SHEET 2 of 18	B

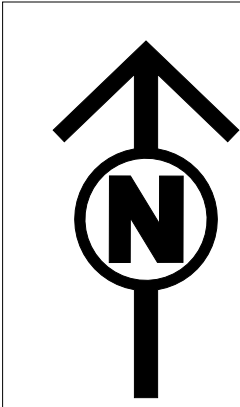

THE NATIONAL GRID (NORWICH TO TILBURY) ORDER
LAND PLANS
REGULATION 5(2)(i)-(iii)
SECTION C (SHEET 3 OF 18,
BABERGH DISTRICT COUNCIL)

Application Document 2.2

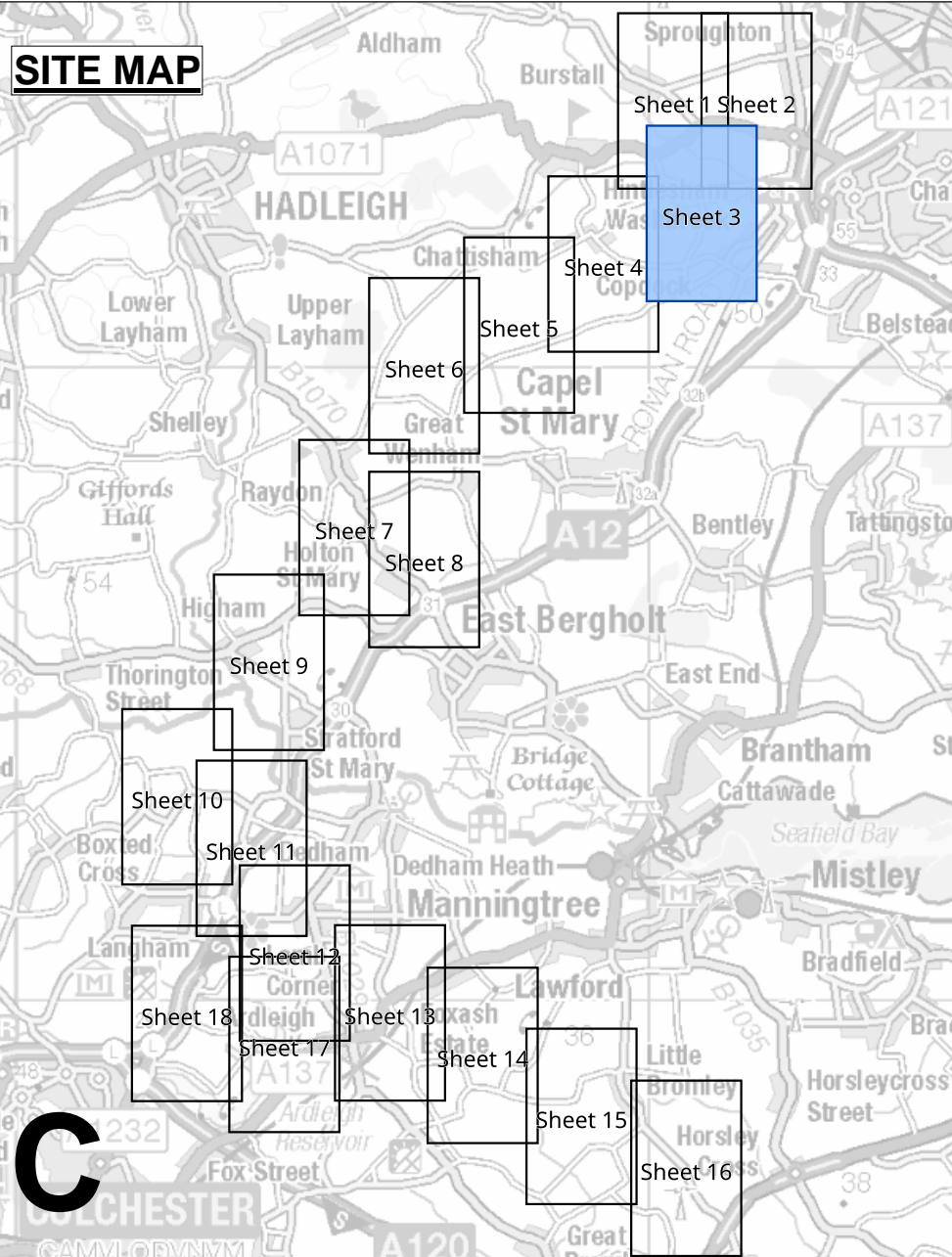

- Legend**
- Local authority boundary
 - Section boundary & local authority boundary
 - Section boundary
 - Sheet index cutlines
 - Order Limits
 - Class 1 - Compulsory acquisition of land
 - Class 2 - Compulsory acquisition of rights - Overhead line
 - Class 3 - Compulsory acquisition of rights - Underground cable system
 - Class 4 - Compulsory acquisition of rights - Overhead line and underground cable system
 - Class 5 - Compulsory acquisition of rights - Access
 - Class 6 - Compulsory acquisition of rights - Drainage
 - Class 7 - Temporary use
 - Class 8 - Land not subject to powers of acquisition nor temporary use

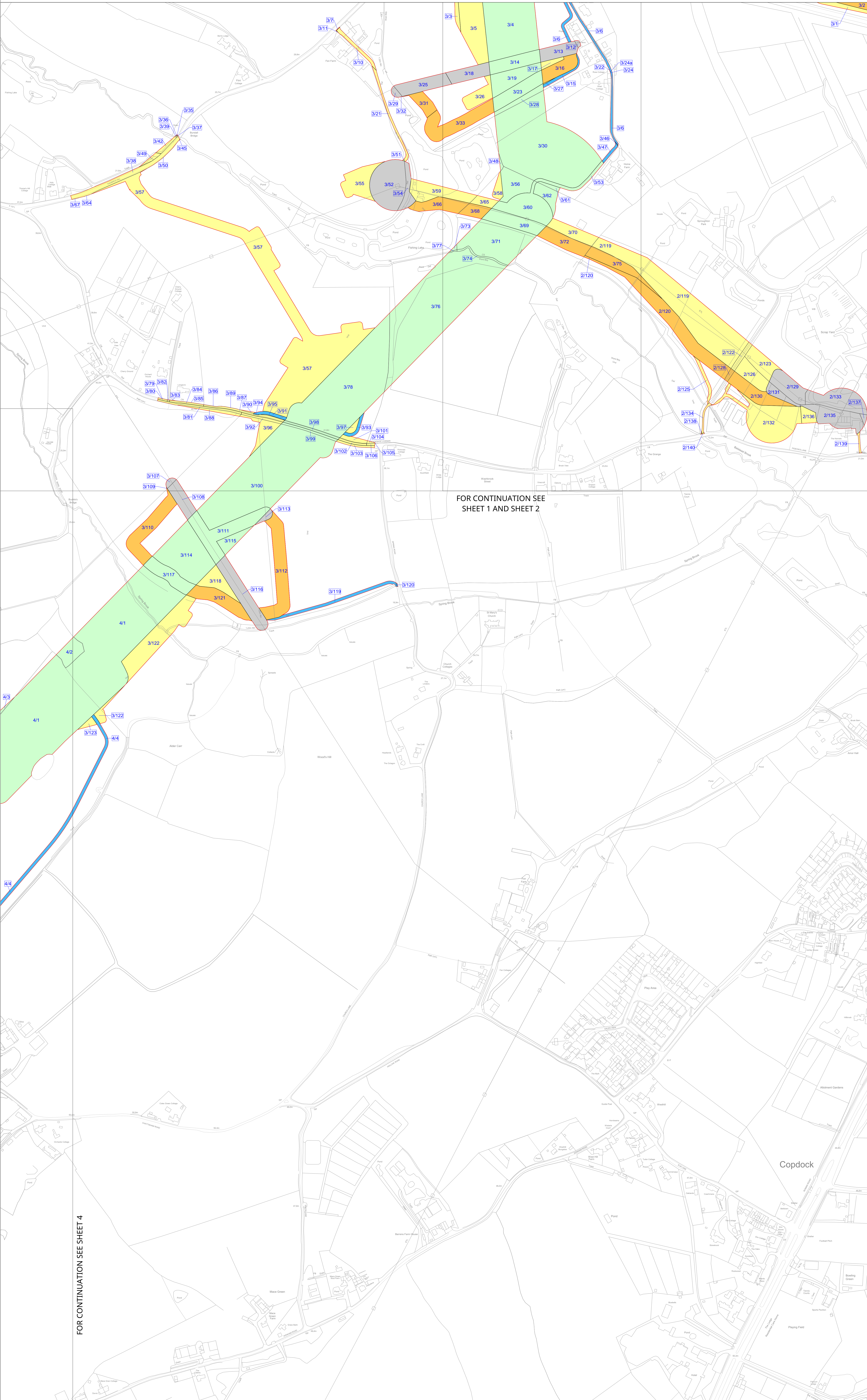

FOR CONTINUATION SEE
SHEET 1 AND SHEET 2

- Notes**
- For additional detail on the plan suites, please refer to the Guide to Plans (document reference 2.0), located in the Volume 2 of the DCO application.
 - This drawing is scaled at paper size A0, therefore any prints taken at smaller sizes will affect accuracy of the measurement units and should not be scaled against.

Coordinate System: British National Grid
Sheet X Centroid Coordinate : 610843 Sheet Y Centroid Coordinate : 242436



BACKGROUND MAPPING INFORMATION HAS BEEN REPRODUCED FROM THE ORDNANCE SURVEY BY PERMISSION OF ORDNANCE SURVEY OF THE CONTROLLER OF HIS MAJESTY'S STATIONERY OFFICE. © CROWN COPYRIGHT AND DATABASE RIGHTS (2025) LICENCE OS100024241 AND AC0000807346.

B	OCT-2025	October 2025 Update	BBU	AMI	CLJ
A	AUG-2025	For DCO submission	BBU	AMI	CLJ

Issue	Date	Remarks	Drawn	Checked	Approved
Title:					

THE NATIONAL GRID
(NORWICH TO TILBURY) ORDER
LAND PLANS
REGULATION 5(2)(i)-(iii)
SECTION C (SHEET 3 OF 18
BABERGH DISTRICT COUNCIL)

nationalgrid

PINS Application Number
EN020027

National Grid Drawing Reference
AENC-TOST-LAN-DWG-0002

Scale	Sheet Size	Sheet	Issue
1:2,500	A0	SHEET 3 of 18	B

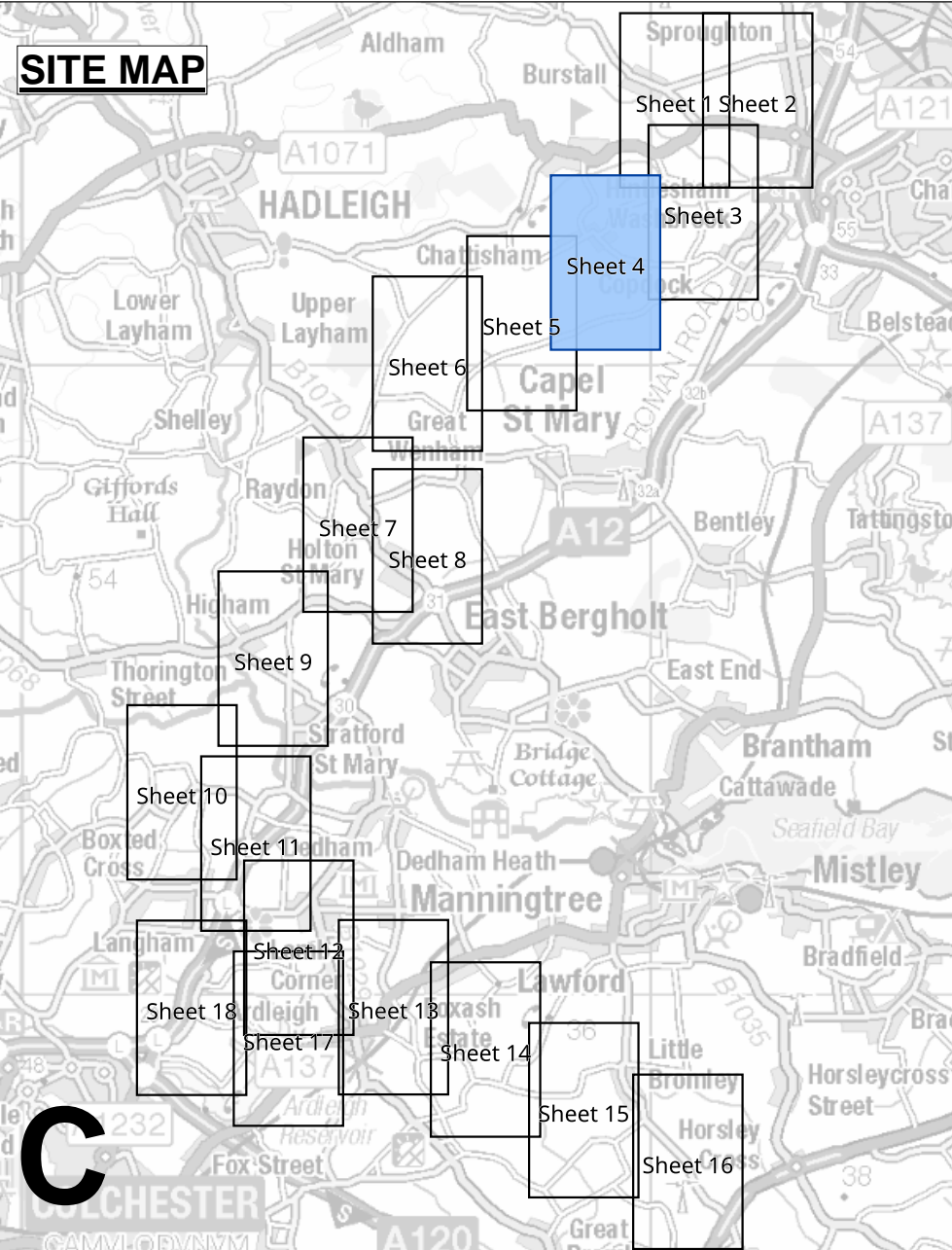
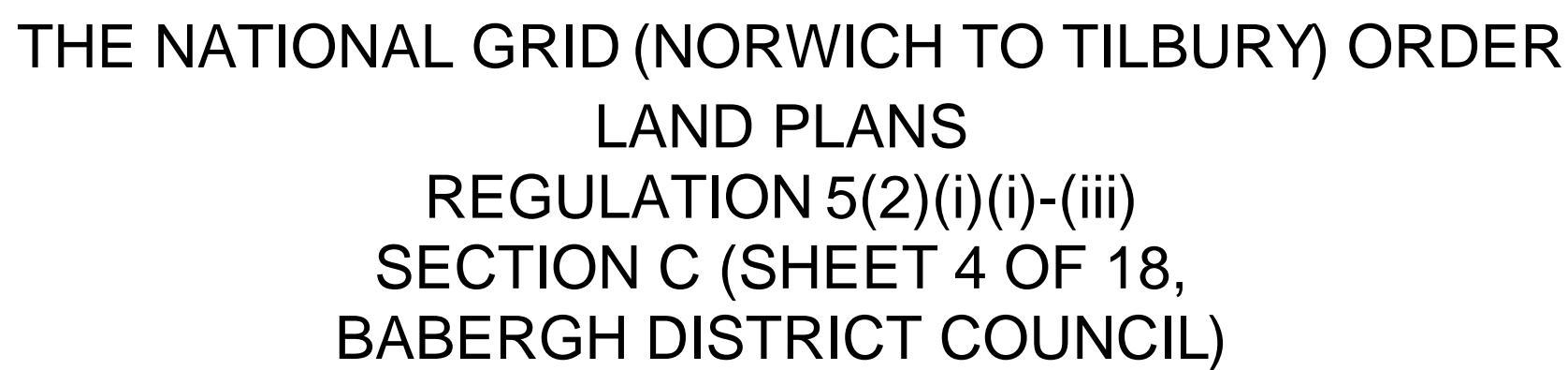

Legend

- Local authority boundary
- Section boundary & local authority boundary
- Section boundary
- Sheet index cutlines
- Order Limits
- Class 1 - Compulsory acquisition of land
- Class 2 - Compulsory acquisition of rights - Overhead line
- Class 3 - Compulsory acquisition of rights - Underground cable system
- Class 4 - Compulsory acquisition of rights - Overhead line and underground cable system
- Class 5 - Compulsory acquisition of rights - Access
- Class 6 - Compulsory acquisition of rights - Drainage
- Class 7 - Temporary use
- Class 8 - Land not subject to powers of acquisition nor temporary use

Notes

1. For additional detail on the plan suites, please refer to the Guide to Plans (document reference 2.0), located in the Volume 2 of the DCO application.

2. This drawing is scaled at paper size A0, therefore any prints taken at smaller sizes will affect accuracy of the measurement units and should not be scaled against.

Coordinate System: British National Grid

Sheet X Centroid Coordinate : 609288

Sheet Y Centroid Coordinate : 24163

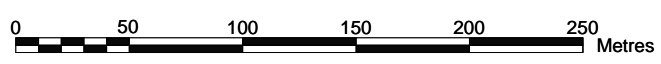

BACKGROUND MAPPING INFORMATION HAS BEEN REPRODUCED FROM THE ORDNANCE SURVEY BY PERMISSION OF ORDNANCE SURVEY OF THE CONTROLLER OF HIS MAJESTY'S STATIONERY OFFICE. © CROWN COPYRIGHT AND DATABASE RIGHTS(2025) LICENCE OS100024241 AND AC0000807948.

B	OCT-2025	October 2025 Update	BBU	AMI	CLJ
A	AUG-2025	For DCO submission	BBU	AMI	CLJ

Issue	Date	Remarks	Drawn	Checked	Approved
-------	------	---------	-------	---------	----------

Title:

THE NATIONAL GRID
(NORWICH TO TILBURY) ORDER
LAND PLANS
REGULATION 5(2)(i)-(iii)
SECTION C (SHEET 4 OF 18
BABERGH DISTRICT COUNCIL)

nationalgrid

PINS Application Number

EN020027

National Grid Drawing Reference

AENC-TQST-LAN-DWG-0002

<u>Scale</u>	<u>Sheet Size</u>	<u>Sheet</u>	<u>Issue</u>
1:2,500	A0	SHEET 4 of 18	B

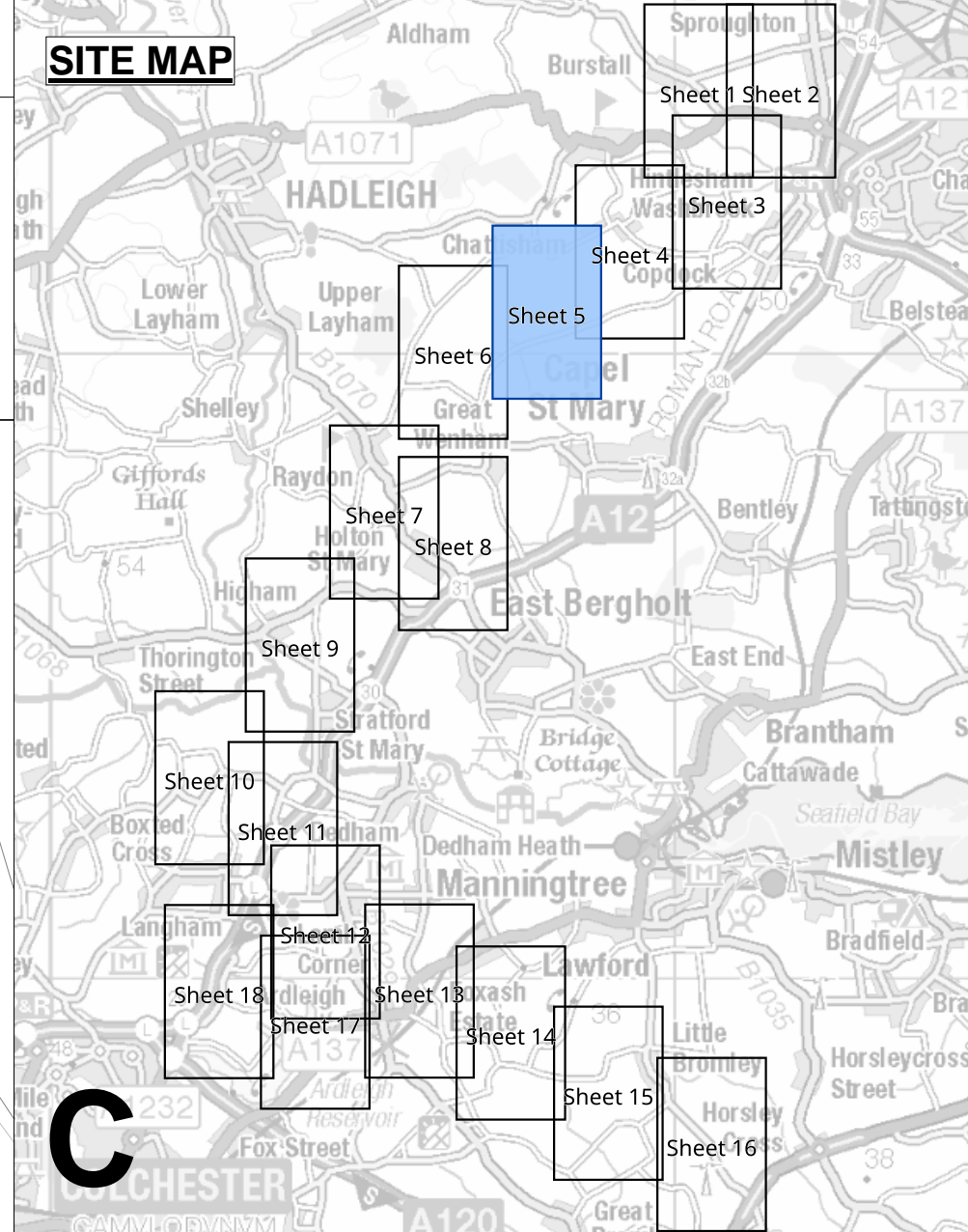
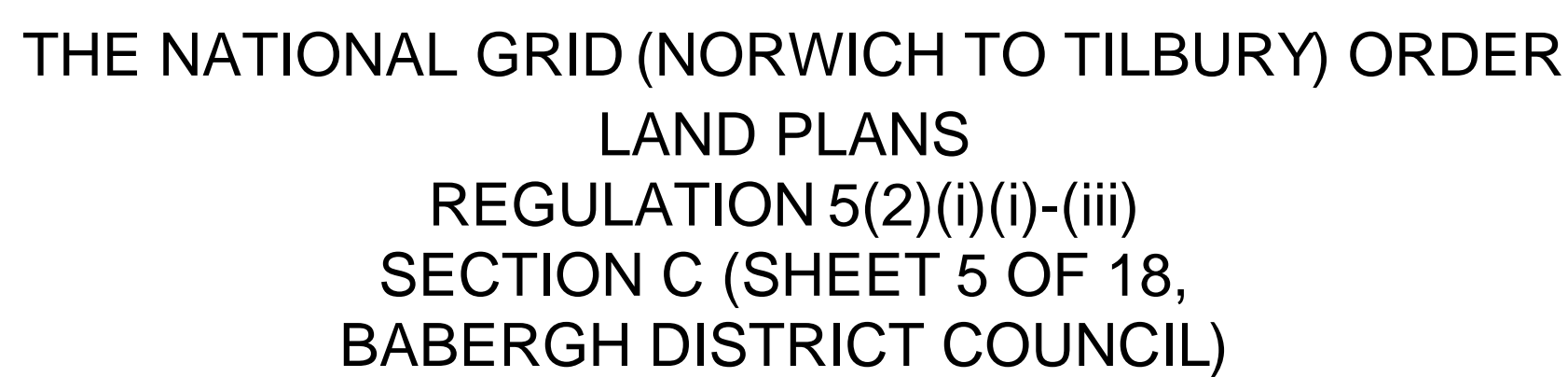

Legend

- Local authority boundary
- Section boundary & local authority boundary
- Section boundary
- Sheet index cutlines
- Order Limits
- Class 1 - Compulsory acquisition of land
- Class 2 - Compulsory acquisition of rights - Overhead line
- Class 3 - Compulsory acquisition of rights - Underground cable system
- Class 4 - Compulsory acquisition of rights - Overhead line and underground cable system
- Class 5 - Compulsory acquisition of rights - Access
- Class 6 - Compulsory acquisition of rights - Drainage
- Class 7 - Temporary use
- Class 8 - Land not subject to powers of acquisition nor temporary use

Notes

1. For additional detail on the plan suites, please refer to the Guide to Plans (document reference 2.0), located in the Volume 2 of the DCO application.
2. This drawing is scaled at paper size A0, therefore any prints taken at smaller sizes will affect accuracy of the measurement units and should not be scaled against.

Coordinate System: British National Grid
Sheet X Centroid Coordinate : 607956 Sheet Y Centroid Coordinate : 240669



BACKGROUND MAPPING INFORMATION HAS BEEN REPRODUCED FROM THE ORDNANCE SURVEY BY PERMISSION OF ORDNANCE SURVEY OF THE CONTROLLER OF HIS MAJESTY'S STATIONERY OFFICE. © CROWN COPYRIGHT AND DATABASE RIGHTS (2025) LICENCE OS100024241 AND AC0000807948.

B	OCT-2025	October 2025 Update	CBE	AMI	CLJ	
A	AUG-2025	For DCO submission	CBE	AMI	CLJ	
Issue	Date	Remarks	Drawn	Checked	Approved	

Title: THE NATIONAL GRID
(NORWICH TO TILBURY) ORDER
LAND PLANS
REGULATION 5(2)(i)-(iii)
SECTION C (SHEET 5 OF 18
BABERGH DISTRICT COUNCIL)

nationalgrid

PINS Application Number EN020027

National Grid Drawing Reference

<u>Scale</u>	<u>Sheet Size</u>	<u>Sheet</u>	<u>Issue</u>
1:2,500	A0	SHEET 5 of 18	B

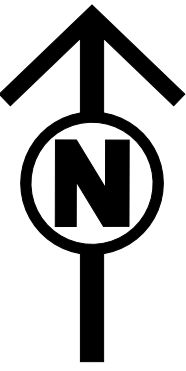

THE NATIONAL GRID (NORWICH TO TILBURY) ORDER
LAND PLANS
REGULATION 5(2)(i)-(iii)
SECTION C (SHEET 6 OF 18,
BABERGH DISTRICT COUNCIL)

Application Document 2.2

SITE MAP

C

Legend

- Local authority boundary
- Section boundary & local authority boundary
- Section boundary
- Sheet index cutlines
- Order Limits
- Class 1 - Compulsory acquisition of land
- Class 2 - Compulsory acquisition of rights - Overhead line
- Class 3 - Compulsory acquisition of rights - Underground cable system
- Class 4 - Compulsory acquisition of rights - Overhead line and underground cable system
- Class 5 - Compulsory acquisition of rights - Access
- Class 6 - Compulsory acquisition of rights - Drainage
- Class 7 - Temporary use
- Class 8 - Land not subject to powers of acquisition nor temporary use

Notes

- For additional detail on the plan suites, please refer to the Guide to Plans (document reference 2.0), located in the Volume 2 of the DCO application.
- This drawing is scaled at paper size A0, therefore any prints taken at smaller sizes will affect accuracy of the measurement units and should not be scaled against.

Coordinate System: British National Grid
Sheet X Centroid Coordinate: 606454 Sheet Y Centroid Coordinate: 240026

0 50 100 150 200 250 Metres

BACKGROUND MAPPING INFORMATION HAS BEEN REPRODUCED FROM THE ORDNANCE SURVEY BY PERMISSION OF ORDNANCE SURVEY OF THE CONTROLLER OF HIS MAJESTY'S STATIONERY OFFICE. © CROWN COPYRIGHT AND DATABASE RIGHTS (2025) LICENCE OS100024241 AND AC000807946.

B	OCT-2025	October 2025 Update	SGR	AMI	CLJ
A	AUG-2025	For DCO submission	SGR	AMI	CLJ

Issue	Date	Remarks	Drawn	Checked	Approved
-------	------	---------	-------	---------	----------

Title:
THE NATIONAL GRID
(NORWICH TO TILBURY) ORDER
LAND PLANS
REGULATION 5(2)(i)-(iii)
SECTION C (SHEET 6 OF 18
BABERGH DISTRICT COUNCIL)

nationalgrid

PINS Application Number
EN020027

National Grid Drawing Reference
AENC-TOST-LAN-DWG-0002

Scale	Sheet Size	Sheet	Issue
1:2,500	A0	SHEET 6 of 18	B

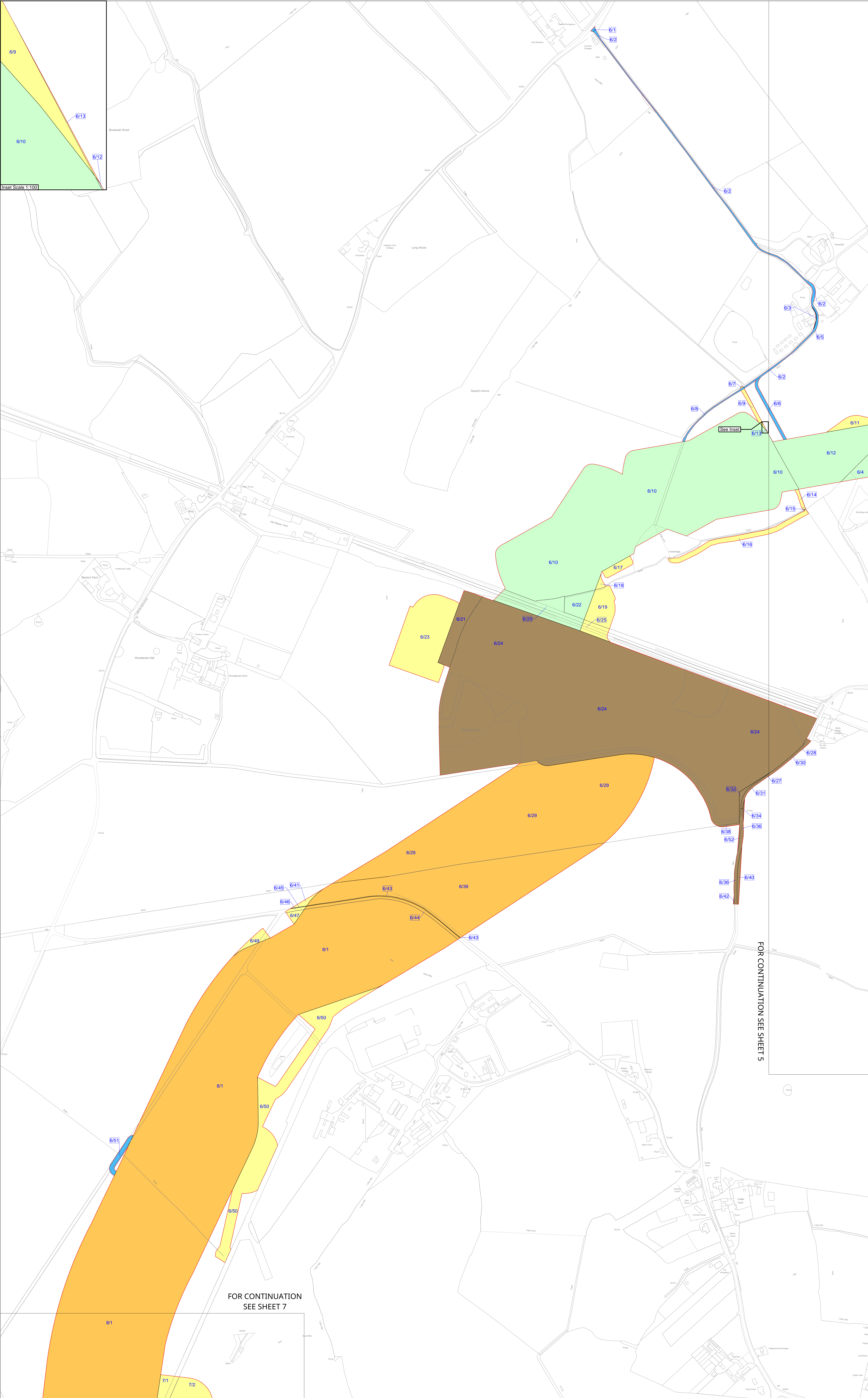

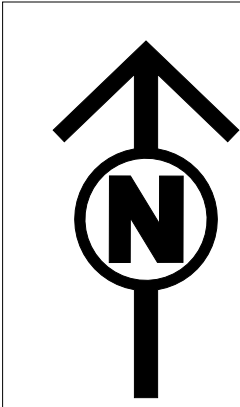

THE NATIONAL GRID (NORWICH TO TILBURY) ORDER
LAND PLANS
REGULATION 5(2)(i)-(iii)
SECTION C (SHEET 7 OF 18,
BABERGH DISTRICT COUNCIL)

Application Document 2.2

SITE MAP

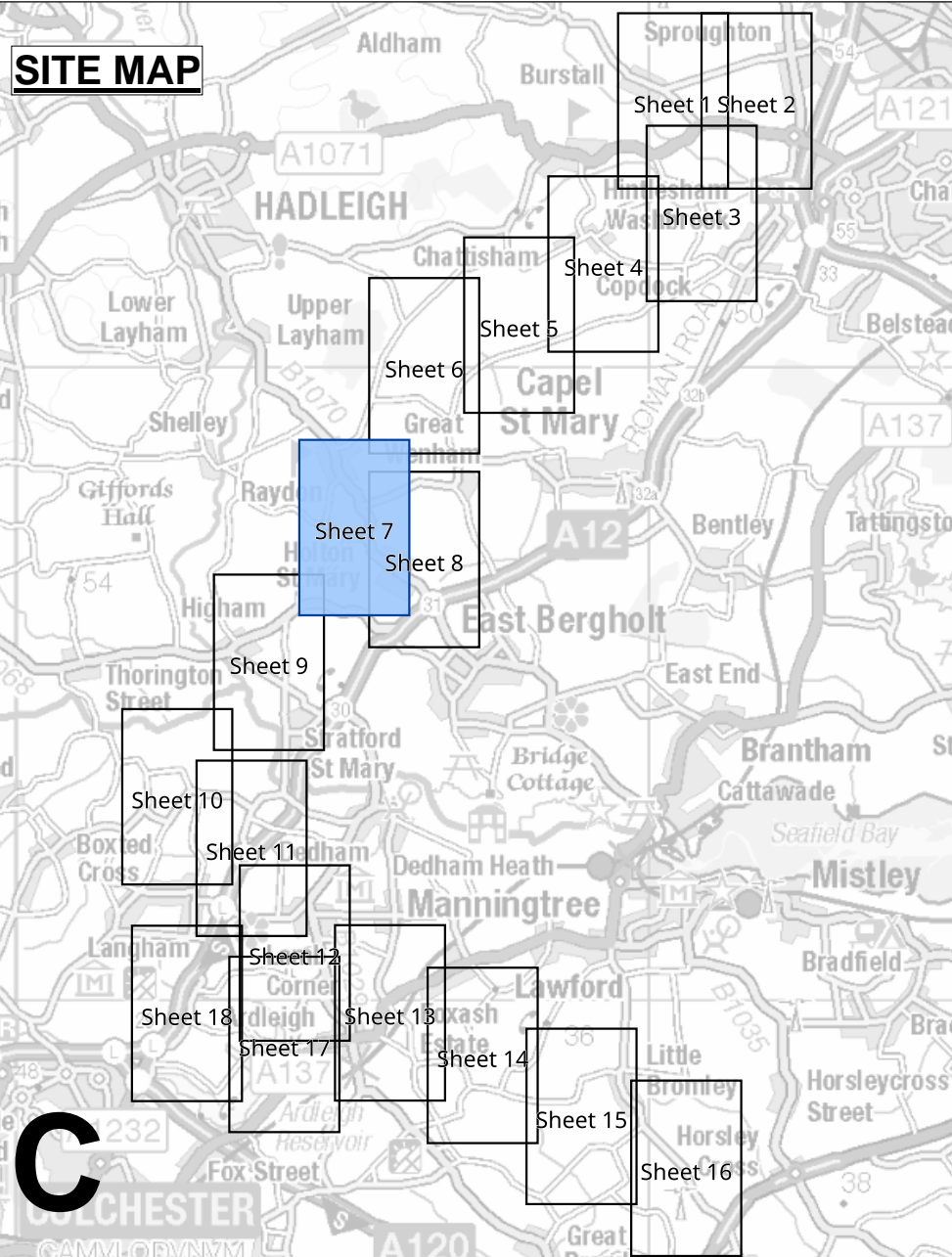

C

Legend

- Local authority boundary
- Section boundary & local authority boundary
- Section boundary
- Sheet index cutlines
- Order Limits
- Class 1 - Compulsory acquisition of land
- Class 2 - Compulsory acquisition of rights - Overhead line
- Class 3 - Compulsory acquisition of rights - Underground cable system
- Class 4 - Compulsory acquisition of rights - Overhead line and underground cable system
- Class 5 - Compulsory acquisition of rights - Access
- Class 6 - Compulsory acquisition of rights - Drainage
- Class 7 - Temporary use
- Class 8 - Land not subject to powers of acquisition nor temporary use

Notes

- For additional detail on the plan suites, please refer to the Guide to Plans (document reference 2.0), located in the Volume 2 of the DCO application.
- This drawing is scaled at paper size A0, therefore any prints taken at smaller sizes will affect accuracy of the measurement units and should not be scaled against.

Coordinate System: British National Grid
Sheet X Centroid Coordinate: 605348 Sheet Y Centroid Coordinate: 237465

0 50 100 150 200 250 Metres

BACKGROUND MAPPING INFORMATION HAS BEEN REPRODUCED FROM THE ORDNANCE SURVEY BY PERMISSION OF ORDNANCE SURVEY OF THE CONTROLLER OF HIS MAJESTY'S STATIONERY OFFICE. © CROWN COPYRIGHT AND DATABASE RIGHTS (2025) LICENCE OS100024241 AND AC0000807946.

B	OCT-2025	October 2025 Update	SGR	AMI	CLJ
A	AUG-2025	For DCO submission	SGR	AMI	CLJ

Issue	Date	Remarks	Drawn	Checked	Approved
-------	------	---------	-------	---------	----------

Title:
THE NATIONAL GRID
(NORWICH TO TILBURY) ORDER
LAND PLANS
REGULATION 5(2)(i)-(iii)
SECTION C (SHEET 7 OF 18
BABERGH DISTRICT COUNCIL)

nationalgrid

PINS Application Number
EN020027

National Grid Drawing Reference
AENC-TQST-LAN-DWG-0002

Scale	Sheet Size	Sheet	Issue
1:2,500	A0	SHEET 7 of 18	B

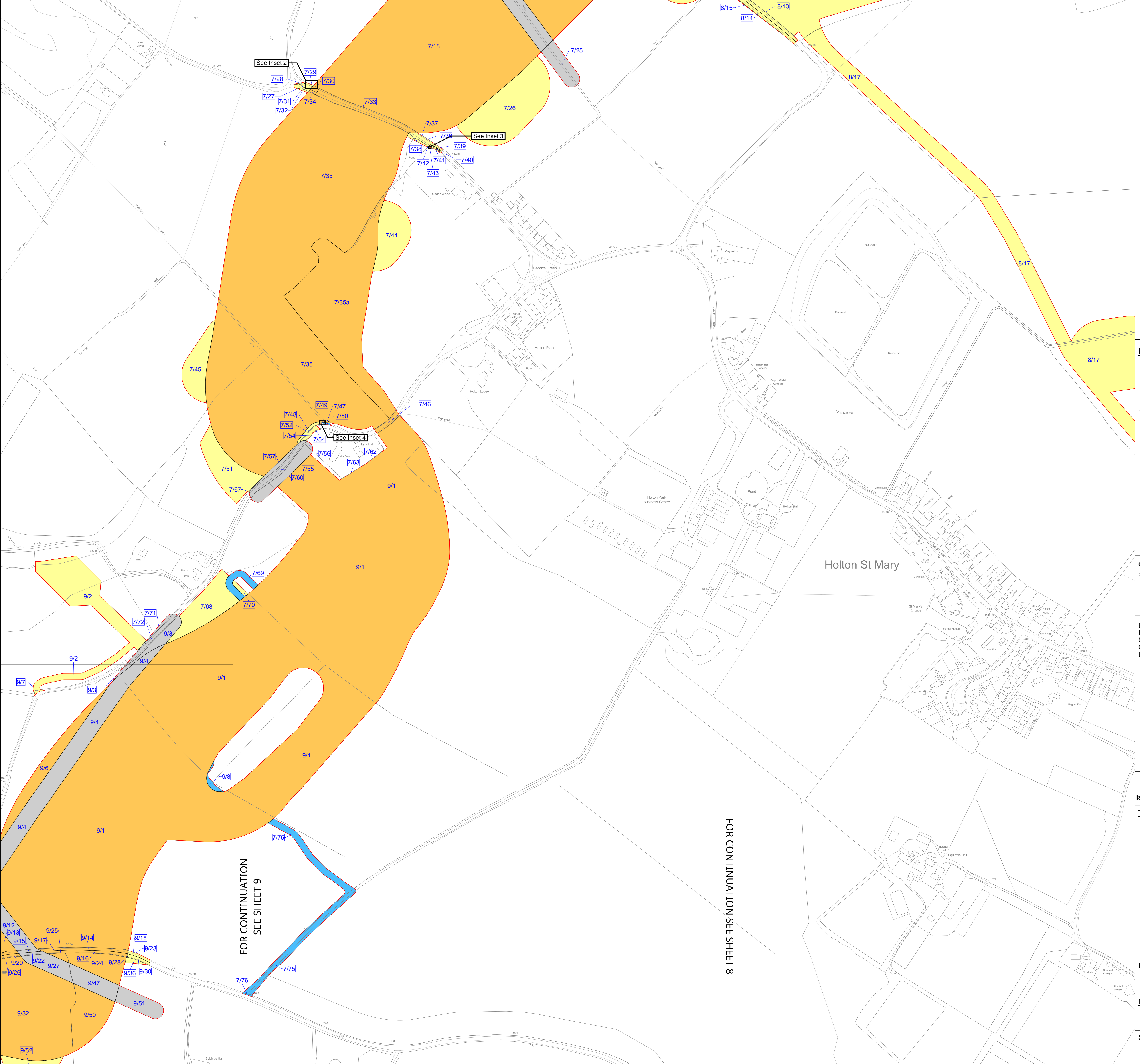
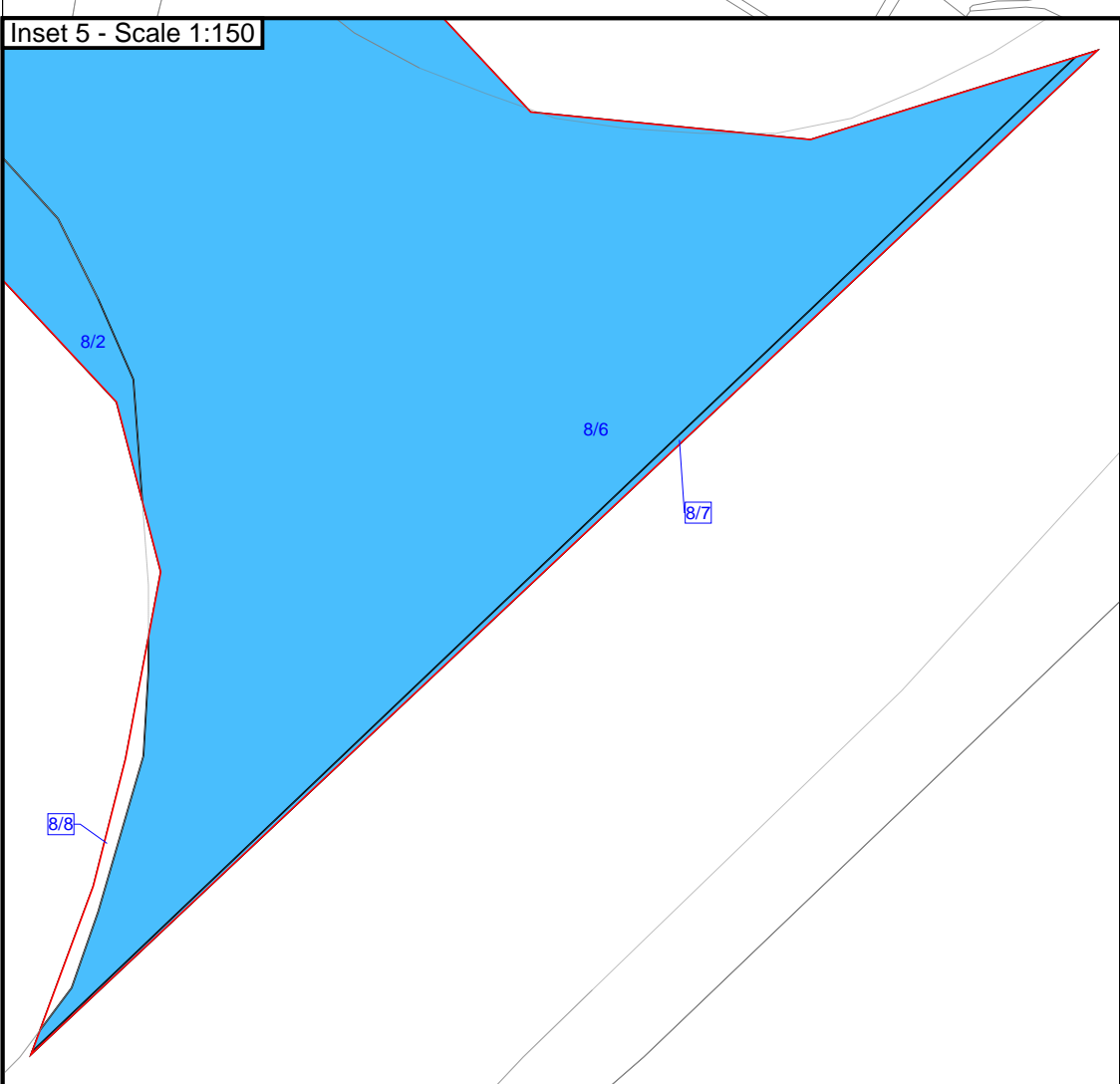
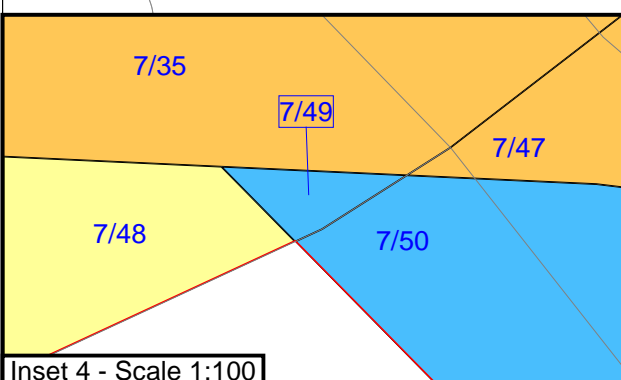
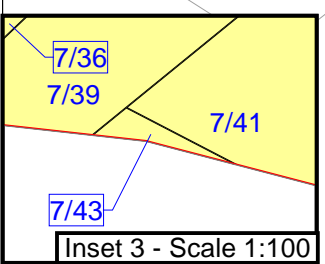
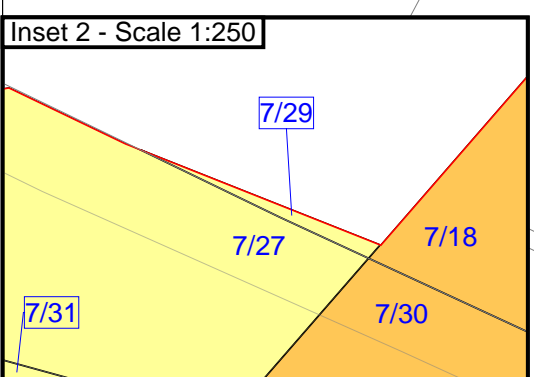
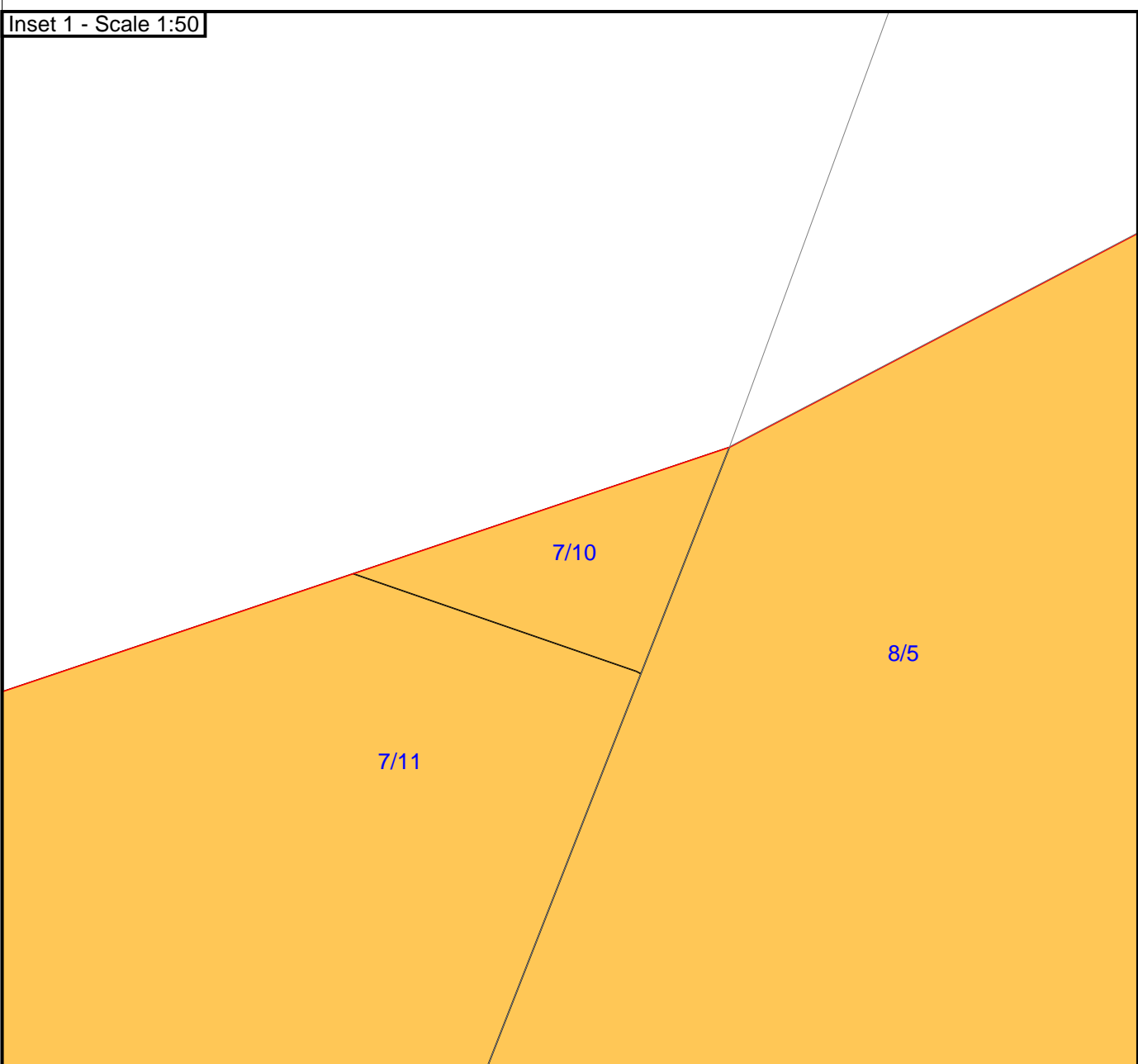

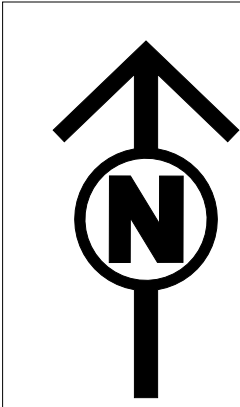

THE NATIONAL GRID (NORWICH TO TILBURY) ORDER
LAND PLANS
REGULATION 5(2)(i)-(iii)
SECTION C (SHEET 8 OF 18,
BABERGH DISTRICT COUNCIL)

Application Document 2.2

SITE MAP

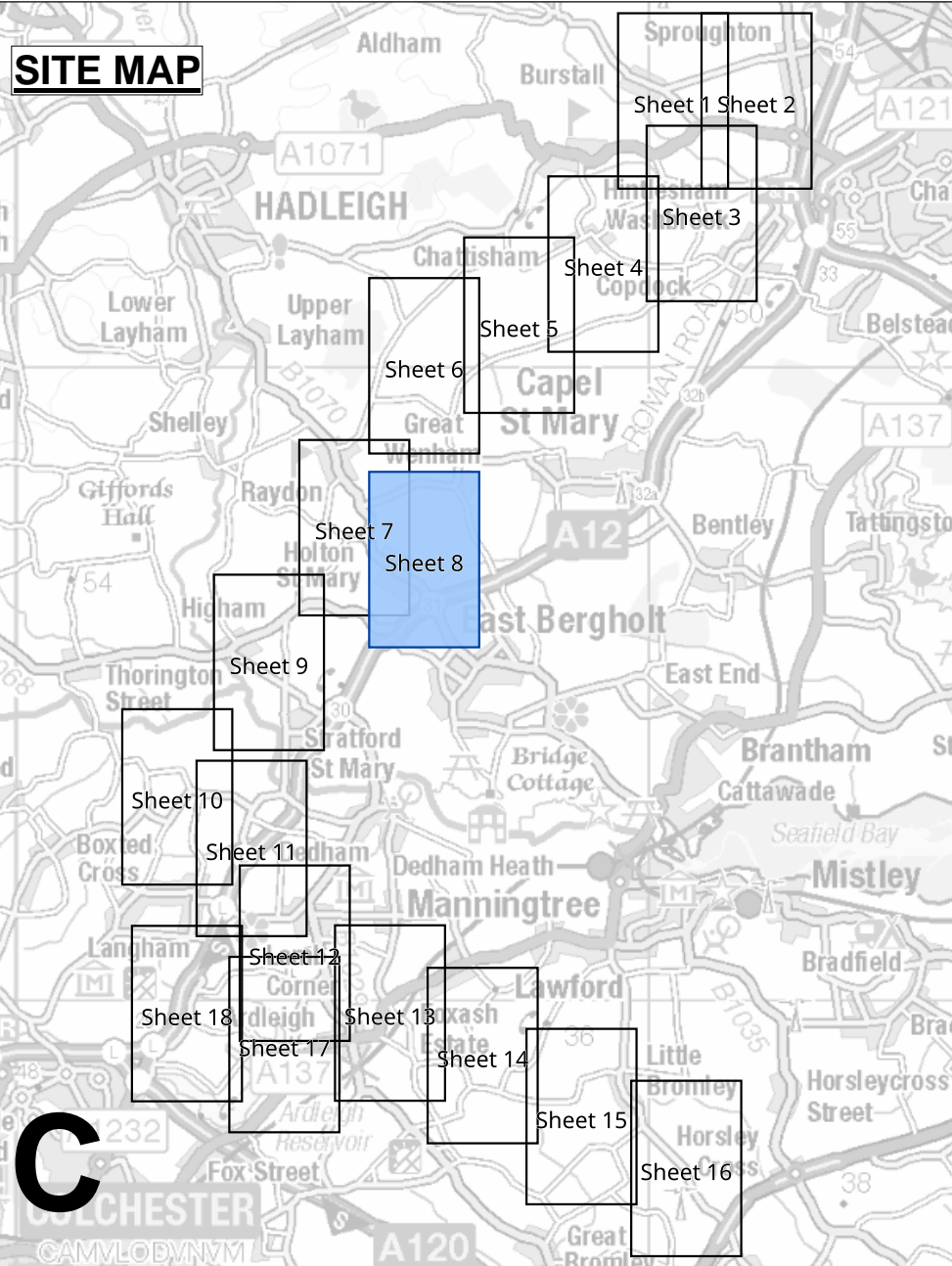

C

Legend

- Local authority boundary
- Section boundary & local authority boundary
- Section boundary
- Sheet index cutlines
- Order Limits
- Class 1 - Compulsory acquisition of land
- Class 2 - Compulsory acquisition of rights - Overhead line
- Class 3 - Compulsory acquisition of rights - Underground cable system
- Class 4 - Compulsory acquisition of rights - Overhead line and underground cable system
- Class 5 - Compulsory acquisition of rights - Access
- Class 6 - Compulsory acquisition of rights - Drainage
- Class 7 - Temporary use
- Class 8 - Land not subject to powers of acquisition nor temporary use

Notes

- For additional detail on the plan suites, please refer to the Guide to Plans (document reference 2.0), located in the Volume 2 of the DCO application.
- This drawing is scaled at paper size A0, therefore any prints taken at smaller sizes will affect accuracy of the measurement units and should not be scaled against.

Coordinate System: British National Grid
Sheet X Centroid Coordinate: 606453 Sheet Y Centroid Coordinate: 236960

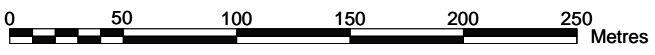

BACKGROUND MAPPING INFORMATION HAS BEEN REPRODUCED FROM THE ORDNANCE SURVEY BY PERMISSION OF ORDNANCE SURVEY OF THE CONTROLLER OF HIS MAJESTY'S STATIONERY OFFICE. © CROWN COPYRIGHT AND DATABASE RIGHTS (2025) LICENCE OS100024241 AND AC0000807946.

B	OCT-2025	October 2025 Update	SGR	AMI	CLJ
A	AUG-2025	For DCO Submission	SGR	AMI	CLJ

Issue	Date	Remarks	Drawn	Checked	Approved
-------	------	---------	-------	---------	----------

Title:
THE NATIONAL GRID
(NORWICH TO TILBURY) ORDER
LAND PLANS
REGULATION 5(2)(i)-(iii)
SECTION C (SHEET 8 OF 18
BABERGH DISTRICT COUNCIL)

nationalgrid

PINS Application Number
EN020027

National Grid Drawing Reference
AENC-TQST-LAN-DWG-0002

Scale	Sheet Size	Sheet	Issue
1:2,500	A0	SHEET 8 of 18	B

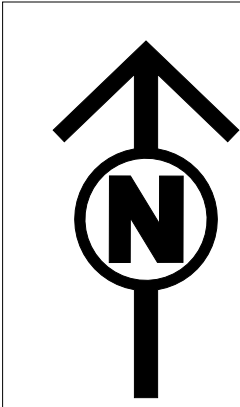

THE NATIONAL GRID (NORWICH TO TILBURY) ORDER
LAND PLANS
REGULATION 5(2)(i)-(iii)
SECTION C (SHEET 9 OF 18,
BABERGH DISTRICT COUNCIL AND COLCHESTER CITY COUNCIL)

Application Document 2.2

SITE MAP

C

Legend

- Local authority boundary
- Section boundary & local authority boundary
- Section boundary
- Sheet index cutlines
- Order Limits
- Class 1 - Compulsory acquisition of land
- Class 2 - Compulsory acquisition of rights - Overhead line
- Class 3 - Compulsory acquisition of rights - Underground cable system
- Class 4 - Compulsory acquisition of rights - Overhead line and underground cable system
- Class 5 - Compulsory acquisition of rights - Access
- Class 6 - Compulsory acquisition of rights - Drainage
- Class 7 - Temporary use
- Class 8 - Land not subject to powers of acquisition nor temporary use

Notes

- For additional detail on the plan suites, please refer to the Guide to Plans (document reference 2.0), located in the Volume 2 of the DCO application.
- This drawing is scaled at paper size A0, therefore any prints taken at smaller sizes will affect accuracy of the measurement units and should not be scaled against.

Coordinate System: British National Grid
Sheet X Centroid Coordinate : 603998 Sheet Y Centroid Coordinate : 235333

BACKGROUND MAPPING INFORMATION HAS BEEN REPRODUCED FROM THE ORDNANCE SURVEY BY PERMISSION OF ORDNANCE SURVEY OF THE CONTROLLER OF HIS MAJESTY'S STATIONERY OFFICE. © CROWN COPYRIGHT AND DATABASE RIGHTS (2025) LICENCE OS100024241 AND AC000807946.

B	OCT-2025	October 2025 Update	SGR	AMI	CLJ
A	AUG-2025	For DCO submission	SGR	AMI	CLJ
Issue	Date	Remarks	Drawn	Checked	Approved
Title:					
THE NATIONAL GRID (NORWICH TO TILBURY) ORDER LAND PLANS REGULATION 5(2)(i)-(iii) SECTION C (SHEET 9 OF 18 BABERGH DISTRICT COUNCIL AND COLCHESTER CITY COUNCIL)					

nationalgrid

PINS Application Number
EN020027

National Grid Drawing Reference
AENC-TQST-LAN-DWG-0002

Scale	Sheet Size	Sheet	Issue
1:2,500	A0	SHEET 9 of 18	B

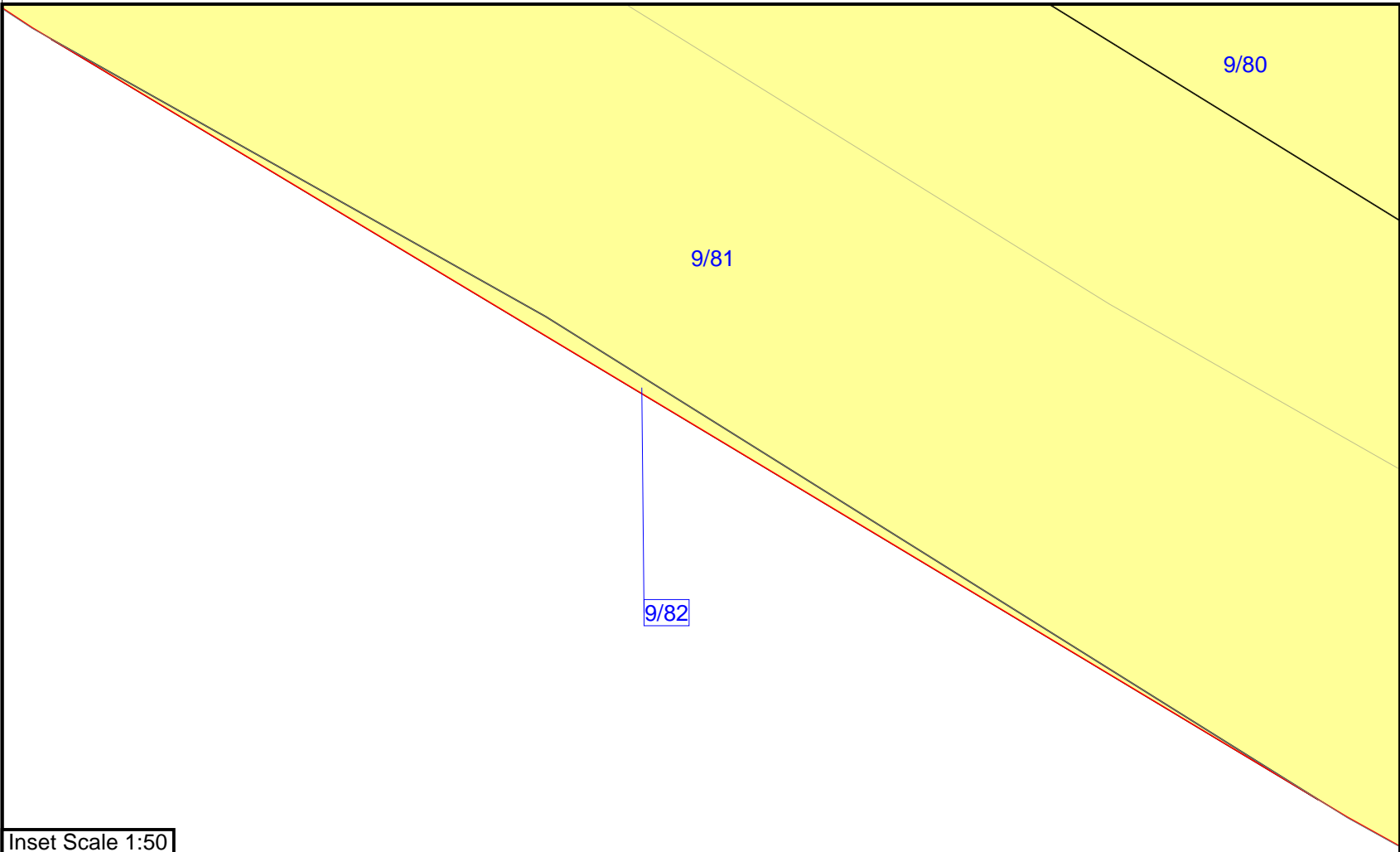

Inset Scale 1:50

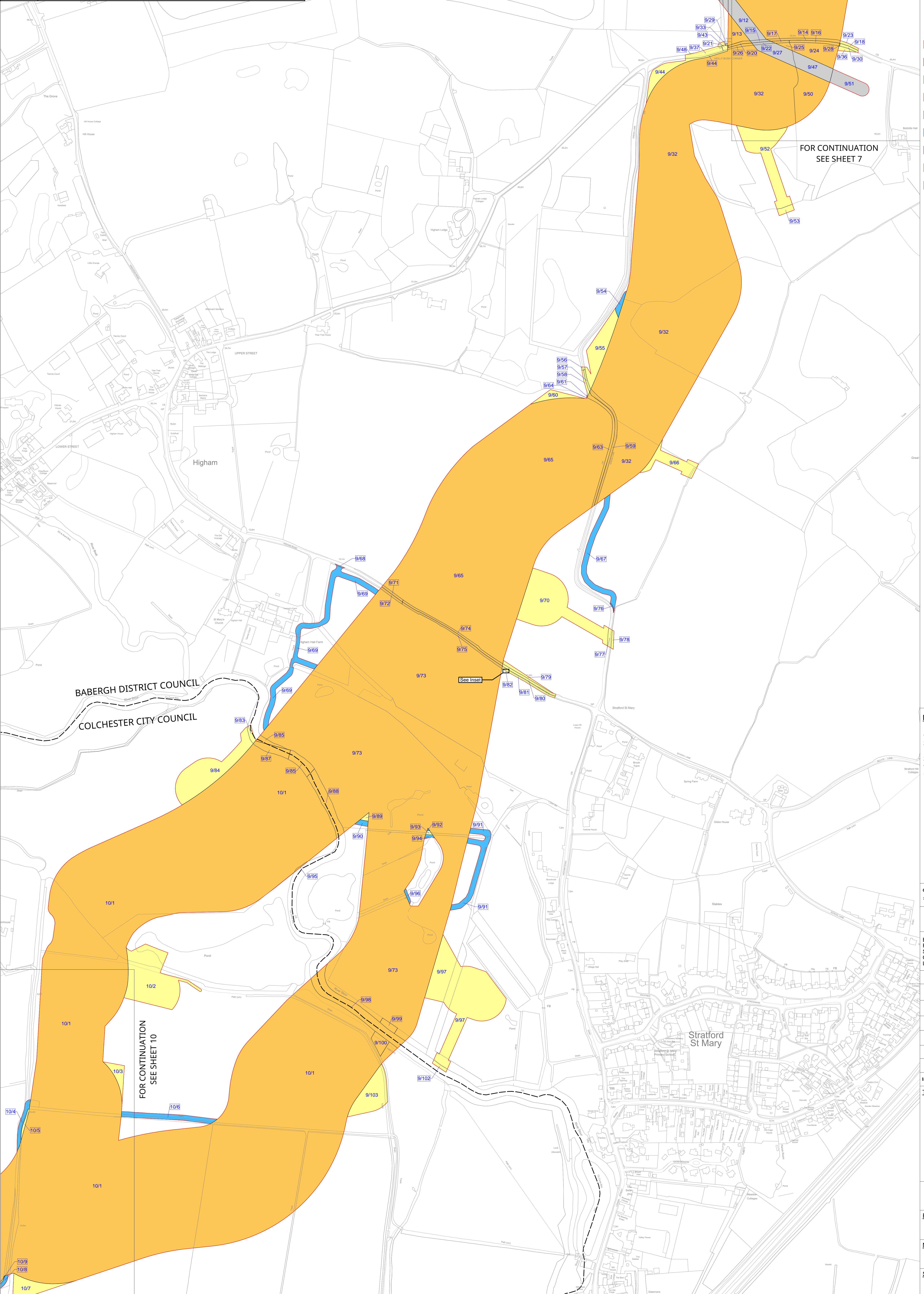

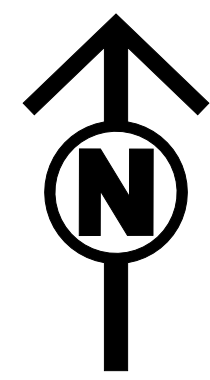

THE NATIONAL GRID (NORWICH TO TILBURY) ORDER
LAND PLANS
REGULATION 5(2)(i)-(iii)
SECTION C (SHEET 10 OF 18,
BABERGH DISTRICT COUNCIL AND COLCHESTER CITY COUNCIL)

Application Document 2.2

SITE MAP

C

Legend

- Local authority boundary
- Section boundary & local authority boundary
- Section boundary
- Sheet index cutlines
- Order Limits
- Class 1 - Compulsory acquisition of land
- Class 2 - Compulsory acquisition of rights - Overhead line
- Class 3 - Compulsory acquisition of rights - Underground cable system
- Class 4 - Compulsory acquisition of rights - Overhead line and underground cable system
- Class 5 - Compulsory acquisition of rights - Access
- Class 6 - Compulsory acquisition of rights - Drainage
- Class 7 - Temporary use
- Class 8 - Land not subject to powers of acquisition nor temporary use

Notes

- For additional detail on the plan suites, please refer to the Guide to Plans (document reference 2.0), located in the Volume 2 of the DCO application.
- This drawing is scaled at paper size A0, therefore any prints taken at smaller sizes will affect accuracy of the measurement units and should not be scaled against.

Coordinate System: British National Grid
Sheet X Centroid Coordinate: 602548 Sheet Y Centroid Coordinate: 233206

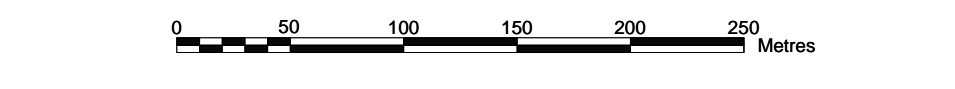

BACKGROUND MAPPING INFORMATION HAS BEEN REPRODUCED FROM THE ORDNANCE SURVEY BY PERMISSION OF ORDNANCE SURVEY OF THE CONTROLLER OF HIS MAJESTY'S STATIONERY OFFICE. © CROWN COPYRIGHT AND DATABASE RIGHTS (2025) LICENCE OS100024241 AND AC000807946.

Issue	Date	Remarks	Drawn	Checked	Approved
B	OCT-2025	October 2025 Update	KRO	AMI	CLJ
A	AUG-2025	For DCO submission	KRO	AMI	CLJ

THE NATIONAL GRID
(NORWICH TO TILBURY) ORDER
LAND PLANS
REGULATION 5(2)(i)-(iii)
SECTION C (SHEET 10 OF 18
BABERGH DISTRICT COUNCIL
AND COLCHESTER CITY COUNCIL)

nationalgrid

PINS Application Number
EN020027

National Grid Drawing Reference
AENC-TOST-LAN-DWG-0002

Scale	Sheet Size	Sheet	Issue
1:2,500	A0	SHEET 10 of 18	B

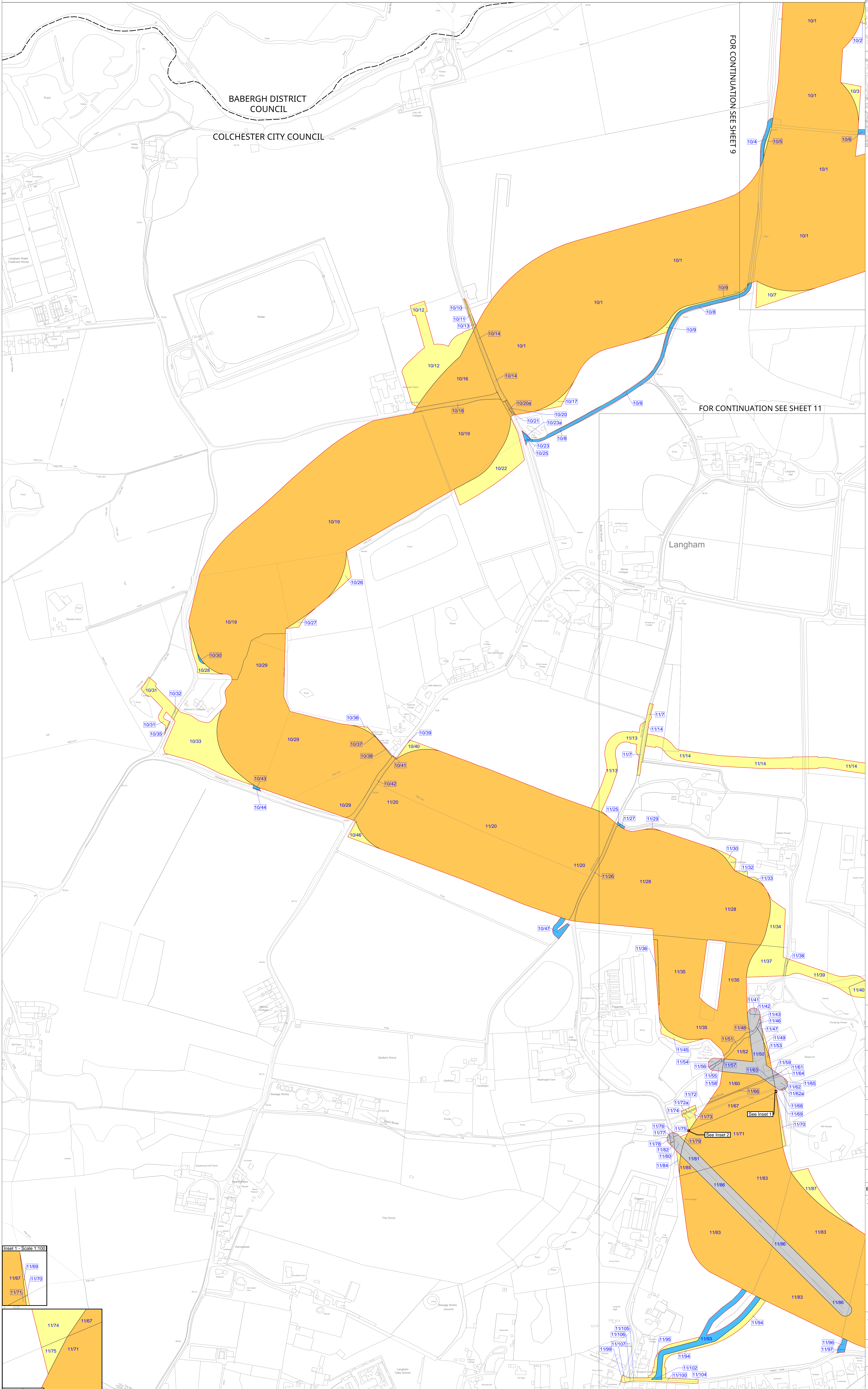

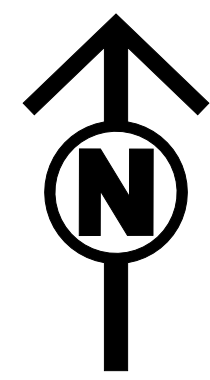

THE NATIONAL GRID (NORWICH TO TILBURY) ORDER
LAND PLANS
REGULATION 5(2)(i)-(iii)
SECTION C (SHEET 11 OF 18,
BABERGH DISTRICT COUNCIL AND COLCHESTER CITY COUNCIL)

Application Document 2.2

SITE MAP

C

Legend

--- Local authority boundary
--- Section boundary & local authority boundary
--- Section boundary
--- Sheet index cutlines
--- Order Limits

- Class 1 - Compulsory acquisition of land
- Class 2 - Compulsory acquisition of rights - Overhead line
- Class 3 - Compulsory acquisition of rights - Underground cable system
- Class 4 - Compulsory acquisition of rights - Overhead line and underground cable system
- Class 5 - Compulsory acquisition of rights - Access
- Class 6 - Compulsory acquisition of rights - Drainage
- Class 7 - Temporary use
- Class 8 - Land not subject to powers of acquisition nor temporary use

Notes

- For additional detail on the plan suites, please refer to the Guide to Plans (document reference 2.0), located in the Volume 2 of the DCO application.
- This drawing is scaled at paper size A0, therefore any prints taken at smaller sizes will affect accuracy of the measurement units and should not be scaled against.

Coordinate System: British National Grid
Sheet X Centroid Coordinate: 603723 Sheet Y Centroid Coordinate: 232390

BACKGROUND MAPPING INFORMATION HAS BEEN REPRODUCED FROM THE ORDNANCE SURVEY BY PERMISSION OF ORDNANCE SURVEY OF THE CONTROLLER OF HIS MAJESTY'S STATIONERY OFFICE. © CROWN COPYRIGHT AND DATABASE RIGHTS (2025) LICENCE OS100024241 AND AC0000807946.

B	OCT-2025	October 2025 Update	KRO	AMI	CLJ
A	AUG-2025	For DCO Submission	KRO	AMI	CLJ

Issue Date Remarks Drawn Checked Approved

Title:
THE NATIONAL GRID
(NORWICH TO TILBURY) ORDER
LAND PLANS
REGULATION 5(2)(i)-(iii)
SECTION C (SHEET 11 OF 18
BABERGH DISTRICT COUNCIL
AND COLCHESTER CITY COUNCIL)

nationalgrid

PINS Application Number
EN020027

National Grid Drawing Reference
AENC-TQST-LAN-DWG-0002

Scale	Sheet Size	Sheet	Issue
1:2,500	A0	SHEET 11 of 18	B

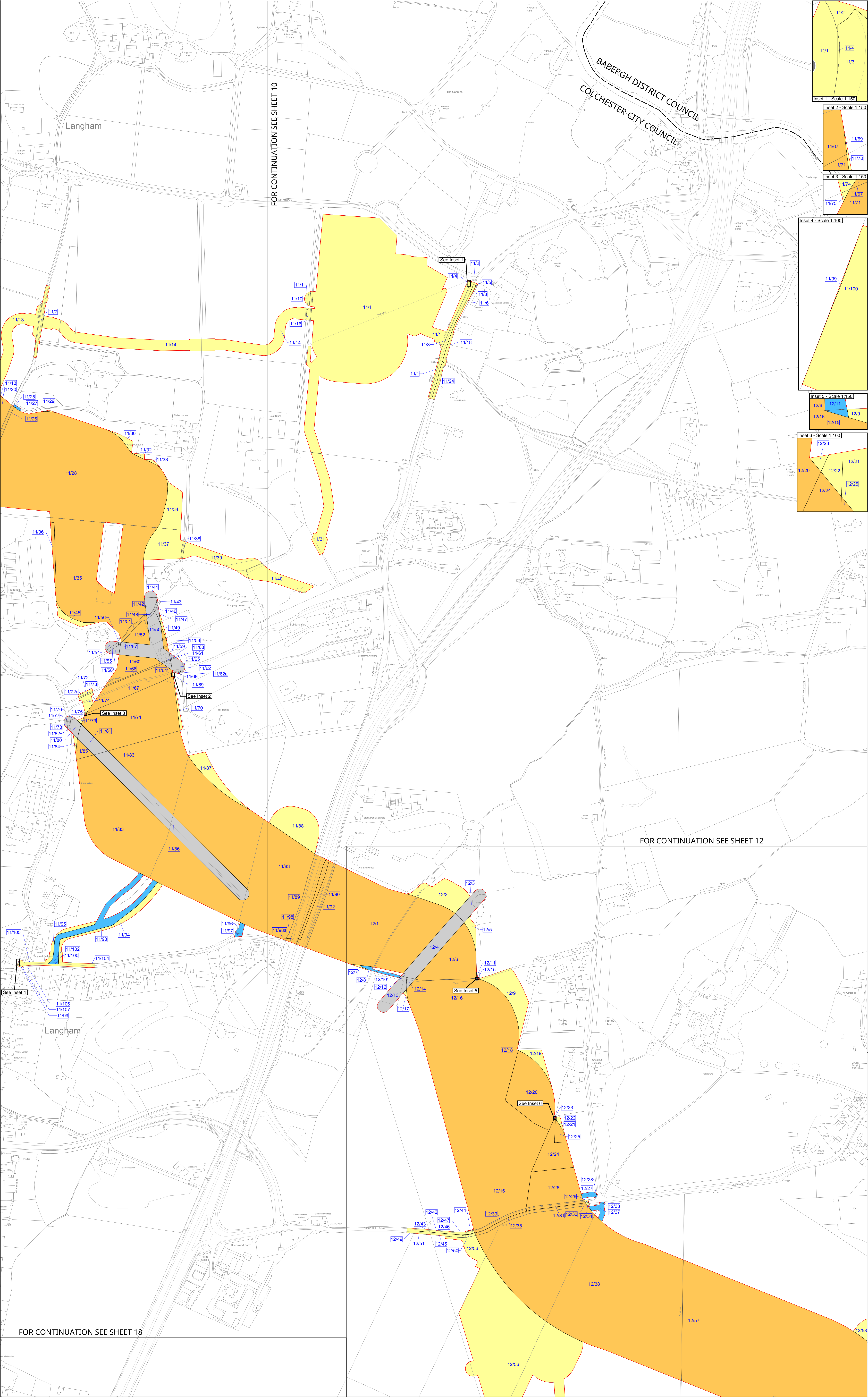

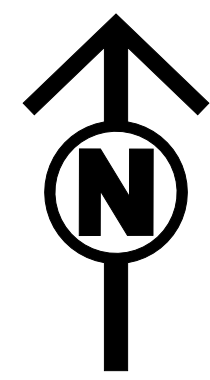

THE NATIONAL GRID (NORWICH TO TILBURY) ORDER
LAND PLANS
REGULATION 5(2)(i)-(iii)
SECTION C (SHEET 12 OF 18,
COLCHESTER CITY COUNCIL AND TENDRING DISTRICT COUNCIL)

Application Document 2.2

SITE MAP

C

Legend

- Local authority boundary
- Section boundary & local authority boundary
- Section boundary
- Sheet index cutlines
- Order Limits
- Class 1 - Compulsory acquisition of land
- Class 2 - Compulsory acquisition of rights - Overhead line
- Class 3 - Compulsory acquisition of rights - Underground cable system
- Class 4 - Compulsory acquisition of rights - Overhead line and underground cable system
- Class 5 - Compulsory acquisition of rights - Access
- Class 6 - Compulsory acquisition of rights - Drainage
- Class 7 - Temporary use
- Class 8 - Land not subject to powers of acquisition nor temporary use

Notes

- For additional detail on the plan suites, please refer to the Guide to Plans (document reference 2.0), located in the Volume 2 of the DCO application.
- This drawing is scaled at paper size A0, therefore any prints taken at smaller sizes will affect accuracy of the measurement units and should not be scaled against.

Coordinate System: British National Grid
Sheet X Centroid Coordinate: 604408 Sheet Y Centroid Coordinate: 230733

BACKGROUND MAPPING INFORMATION HAS BEEN REPRODUCED FROM THE ORDNANCE SURVEY BY PERMISSION OF ORDNANCE SURVEY OF THE CONTROLLER OF HIS MAJESTY'S STATIONERY OFFICE. © CROWN COPYRIGHT AND DATABASE RIGHTS (2025) LICENCE OS100024241 AND AC000807946.

B	OCT-2025	October 2025 Update	KRO	AMI	CLJ
A	AUG-2025	For DCO Submission	KRO	AMI	CLJ

Issue	Date	Remarks	Drawn	Checked	Approved
-------	------	---------	-------	---------	----------

Title:
THE NATIONAL GRID
(NORWICH TO TILBURY) ORDER
LAND PLANS
REGULATION 5(2)(i)-(iii)
SECTION C (SHEET 12 OF 18
COLCHESTER CITY COUNCIL
AND TENDRING DISTRICT COUNCIL)

nationalgrid

PINS Application Number
EN020027

National Grid Drawing Reference
AENC-TOST-LAN-DWG-0002

Scale	Sheet Size	Sheet	Issue
1:2,500	A0	SHEET 12 of 18	B

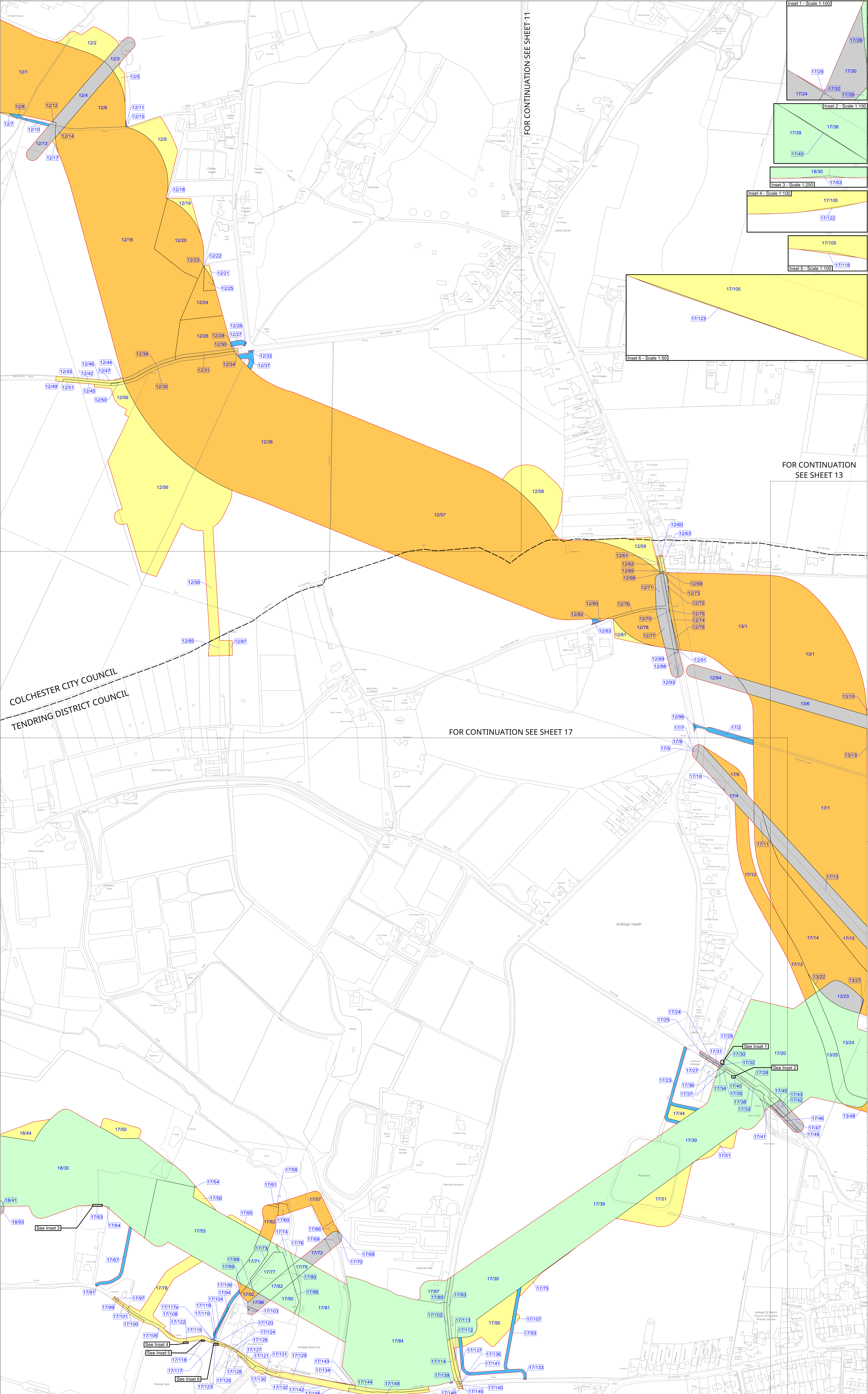

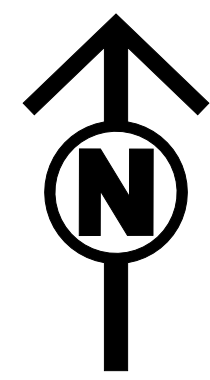

THE NATIONAL GRID (NORWICH TO TILBURY) ORDER
LAND PLANS
REGULATION 5(2)(i)-(iii)
SECTION C (SHEET 13 OF 18,
COLCHESTER CITY COUNCIL AND TENDRING DISTRICT COUNCIL)

Application Document 2.2

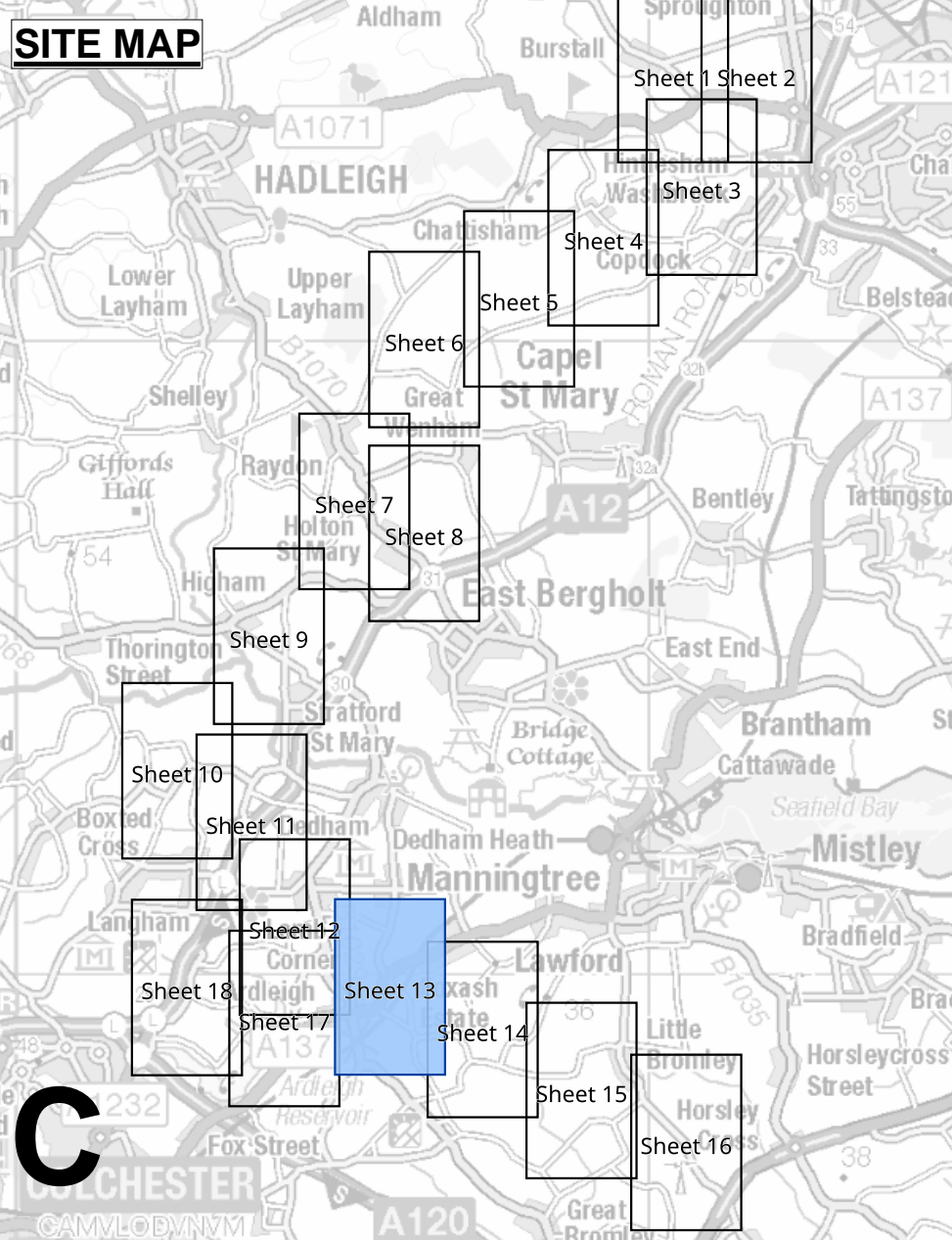

- Legend**
- Local authority boundary
 - Section boundary & local authority boundary
 - Section boundary
 - Sheet index cutlines
 - Order Limits
 - Class 1 - Compulsory acquisition of land
 - Class 2 - Compulsory acquisition of rights - Overhead line
 - Class 3 - Compulsory acquisition of rights - Underground cable system
 - Class 4 - Compulsory acquisition of rights - Overhead line and underground cable system
 - Class 5 - Compulsory acquisition of rights - Access
 - Class 6 - Compulsory acquisition of rights - Drainage
 - Class 7 - Temporary use
 - Class 8 - Land not subject to powers of acquisition nor temporary use

FOR CONTINUATION
SEE SHEET 12

COLCHESTER CITY COUNCIL
TENDRING DISTRICT COUNCIL

FOR CONTINUATION SEE SHEET 14

FOR CONTINUATION SEE SHEET 17

- Notes**
- For additional detail on the plan suites, please refer to the Guide to Plans (document reference 2.0), located in the Volume 2 of the DCO application.
 - This drawing is scaled at paper size A0, therefore any prints taken at smaller sizes will affect accuracy of the measurement units and should not be scaled against.

Coordinate System: British National Grid
Sheet X Centroid Coordinate : 605913 Sheet Y Centroid Coordinate : 229787

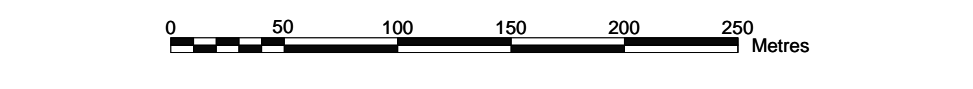

BACKGROUND MAPPING INFORMATION HAS BEEN REPRODUCED FROM THE ORDNANCE SURVEY BY PERMISSION OF ORDNANCE SURVEY OF THE CONTROLLER OF HIS MAJESTY'S STATIONERY OFFICE. © CROWN COPYRIGHT AND DATABASE RIGHTS (2025) LICENCE OS100024241 AND AC000807946.

B	OCT-2025	October 2025 Update	KRO	AMI	CLJ
A	AUG-2025	For DCO submission	KRO	AMI	CLJ

Issue	Date	Remarks	Drawn	Checked	Approved
-------	------	---------	-------	---------	----------

Title:
THE NATIONAL GRID
(NORWICH TO TILBURY) ORDER
LAND PLANS
REGULATION 5(2)(i)-(iii)
SECTION C (SHEET 13 OF 18
COLCHESTER CITY COUNCIL
AND TENDRING DISTRICT COUNCIL)

nationalgrid

PINS Application Number
EN020027

National Grid Drawing Reference
AENC-TOST-LAN-DWG-0002

Scale	Sheet Size	Sheet	Issue
1:2,500	A0	SHEET 13 of 18	B

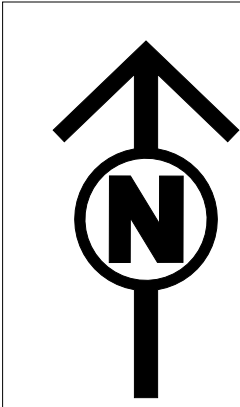

THE NATIONAL GRID (NORWICH TO TILBURY) ORDER
LAND PLANS
REGULATION 5(2)(i)-(iii)
SECTION C (SHEET 14 OF 18,
TENDRING DISTRICT COUNCIL)

Application Document 2.2

SITE MAP

C

Legend

- Local authority boundary
- Section boundary & local authority boundary
- Section boundary
- Sheet index cutlines
- Order Limits
- Class 1 - Compulsory acquisition of land
- Class 2 - Compulsory acquisition of rights - Overhead line
- Class 3 - Compulsory acquisition of rights - Underground cable system
- Class 4 - Compulsory acquisition of rights - Overhead line and underground cable system
- Class 5 - Compulsory acquisition of rights - Access
- Class 6 - Compulsory acquisition of rights - Drainage
- Class 7 - Temporary use
- Class 8 - Land not subject to powers of acquisition nor temporary use

Notes

- For additional detail on the plan suites, please refer to the Guide to Plans (document reference 2.0), located in the Volume 2 of the DCO application.
- This drawing is scaled at paper size A0, therefore any prints taken at smaller sizes will affect accuracy of the measurement units and should not be scaled against.

Coordinate System: British National Grid
Sheet X Centroid Coordinate: 607378 Sheet Y Centroid Coordinate: 229114

BACKGROUND MAPPING INFORMATION HAS BEEN REPRODUCED FROM THE ORDNANCE SURVEY BY PERMISSION OF ORDNANCE SURVEY OF THE CONTROLLER OF HIS MAJESTY'S STATIONERY OFFICE. © CROWN COPYRIGHT AND DATABASE RIGHTS (2025) LICENCE OS100024241 AND AC0000807946.

THE NATIONAL GRID
(NORWICH TO TILBURY) ORDER
LAND PLANS
REGULATION 5(2)(i)-(iii)
SECTION C (SHEET 14 OF 18
TENDRING DISTRICT COUNCIL)

nationalgrid				
PINS Application Number				
EN020027				
National Grid Drawing Reference				
AENC-TQST-LAN-DWG-0002				
Scale	Sheet Size	Sheet	Issue	
1:2,500	A0	SHEET 14 of 18	B	

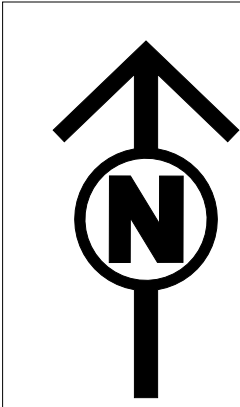

THE NATIONAL GRID (NORWICH TO TILBURY) ORDER
LAND PLANS
REGULATION 5(2)(i)-(iii)
SECTION C (SHEET 15 OF 18,
TENDRING DISTRICT COUNCIL)

Application Document 2.2

SITE MAP

Legend

- Local authority boundary
- Section boundary & local authority boundary
- Section boundary
- Sheet index cutlines
- Order Limits
- Class 1 - Compulsory acquisition of land
- Class 2 - Compulsory acquisition of rights - Overhead line
- Class 3 - Compulsory acquisition of rights - Underground cable system
- Class 4 - Compulsory acquisition of rights - Overhead line and underground cable system
- Class 5 - Compulsory acquisition of rights - Access
- Class 6 - Compulsory acquisition of rights - Drainage
- Class 7 - Temporary use
- Class 8 - Land not subject to powers of acquisition nor temporary use

Notes

- For additional detail on the plan suites, please refer to the Guide to Plans (document reference 2.0), located in the Volume 2 of the DCO application.
- This drawing is scaled at paper size A0, therefore any prints taken at smaller sizes will affect accuracy of the measurement units and should not be scaled against.

Coordinate System: British National Grid
Sheet X Centroid Coordinate: 608942 Sheet Y Centroid Coordinate: 228148

BACKGROUND MAPPING INFORMATION HAS BEEN REPRODUCED FROM THE ORDNANCE SURVEY BY PERMISSION OF ORDNANCE SURVEY OF THE CONTROLLER OF HIS MAJESTY'S STATIONERY OFFICE. © CROWN COPYRIGHT AND DATABASE RIGHTS (2025) LICENCE OS100024241 AND AC0000807946.

B	OCT-2025	October 2025 Update	CBE	AMI	CLJ
A	AUG-2025	For DCO submission	CBE	AMI	CLJ
Issue	Date	Remarks	Drawn	Checked	Approved
Title:					
THE NATIONAL GRID (NORWICH TO TILBURY) ORDER LAND PLANS REGULATION 5(2)(i)-(iii) SECTION C (SHEET 15 OF 18 TENDRING DISTRICT COUNCIL)					

nationalgrid

PINS Application Number			
EN020027			
National Grid Drawing Reference			
AENC-TQST-LAN-DWG-0002			
Scale	Sheet Size	Sheet	Issue
1:2,500	A0	SHEET 15 of 18	B

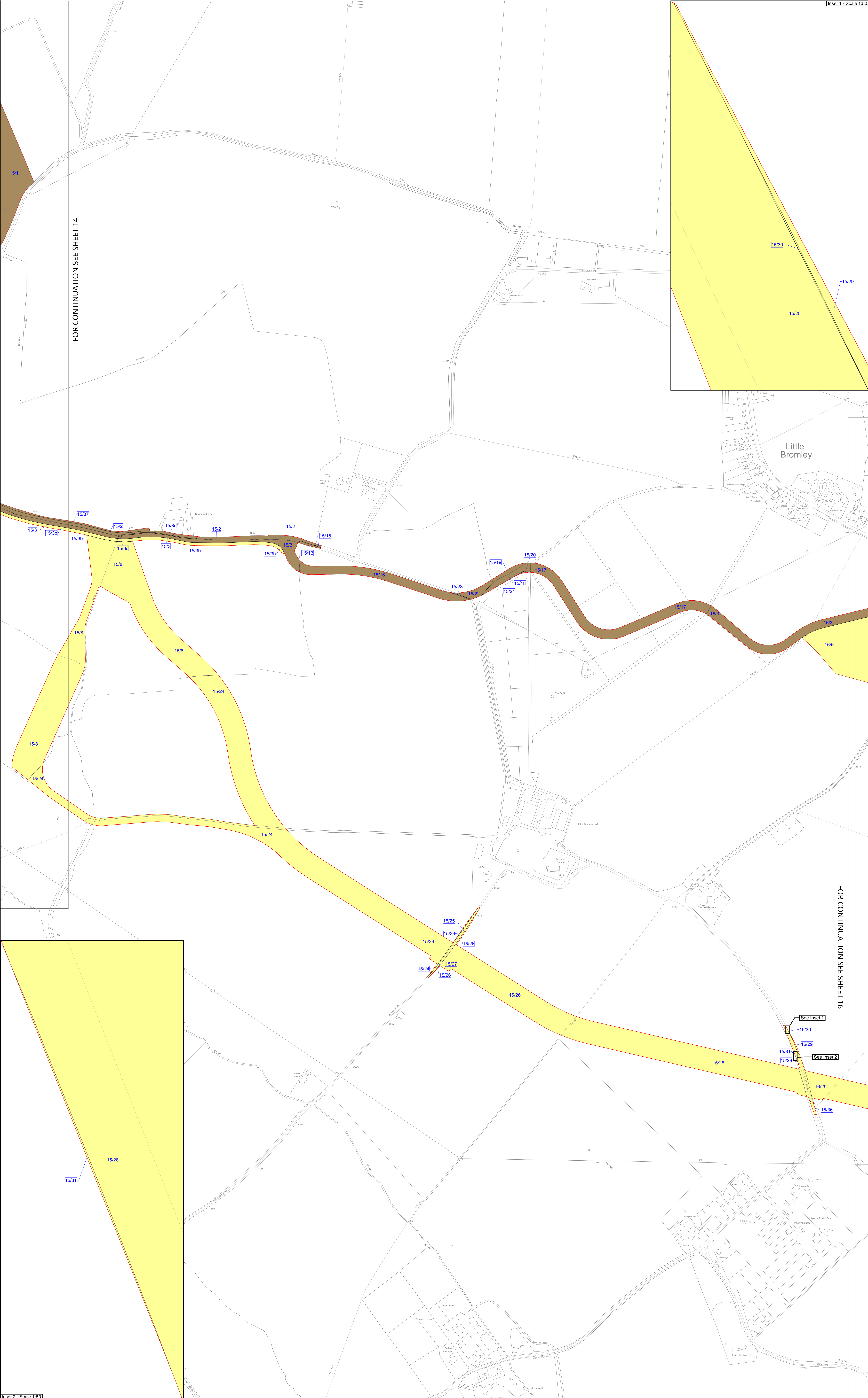

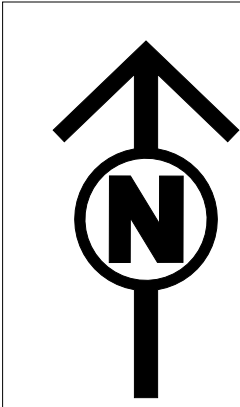

THE NATIONAL GRID (NORWICH TO TILBURY) ORDER
LAND PLANS
REGULATION 5(2)(i)-(iii)
SECTION C (SHEET 16 OF 18,
TENDRING DISTRICT COUNCIL)

Application Document 2.2

SITE MAP

C

Legend

- Local authority boundary
- Section boundary & local authority boundary
- Section boundary
- Sheet index cutlines
- Order Limits
- Class 1 - Compulsory acquisition of land
- Class 2 - Compulsory acquisition of rights - Overhead line
- Class 3 - Compulsory acquisition of rights - Underground cable system
- Class 4 - Compulsory acquisition of rights - Overhead line and underground cable system
- Class 5 - Compulsory acquisition of rights - Access
- Class 6 - Compulsory acquisition of rights - Drainage
- Class 7 - Temporary use
- Class 8 - Land not subject to powers of acquisition nor temporary use

Notes

- For additional detail on the plan suites, please refer to the Guide to Plans (document reference 2.0), located in the Volume 2 of the DCO application.
- This drawing is scaled at paper size A0, therefore any prints taken at smaller sizes will affect accuracy of the measurement units and should not be scaled against.

Coordinate System: British National Grid
Sheet X Centroid Coordinate : 610699 Sheet Y Centroid Coordinate : 227327



BACKGROUND MAPPING INFORMATION HAS BEEN REPRODUCED FROM THE ORDNANCE SURVEY BY PERMISSION OF ORDNANCE SURVEY OF THE CONTROLLER OF HIS MAJESTY'S STATIONERY OFFICE. © CROWN COPYRIGHT AND DATABASE RIGHTS (2025) LICENCE OS100024241 AND AC000807346.

B	OCT-2025	October 2025 Update	CBE	AMI	CLJ
A	AUG-2025	For DCO submission	CBE	AMI	CLJ

Issue	Date	Remarks	Drawn	Checked	Approved
-------	------	---------	-------	---------	----------

Title:
THE NATIONAL GRID
(NORWICH TO TILBURY) ORDER
LAND PLANS
REGULATION 5(2)(i)-(iii)
SECTION C (SHEET 16 OF 18
TENDRING DISTRICT COUNCIL)

nationalgrid

PINS Application Number
EN020027

National Grid Drawing Reference
AENC-TQST-LAN-DWG-0002

Scale	Sheet Size	Sheet	Issue
1:2,500	A0	SHEET 16 of 18	B

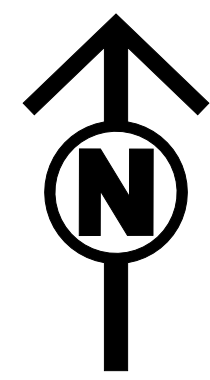

THE NATIONAL GRID (NORWICH TO TILBURY) ORDER
LAND PLANS
REGULATION 5(2)(i)-(iii)
SECTION C (SHEET 17 OF 18,
COLCHESTER CITY COUNCIL AND TENDRING DISTRICT COUNCIL)

Application Document 2.2

SITE MAP

C

Legend

- Local authority boundary
- Section boundary & local authority boundary
- Section boundary
- Sheet index cutlines
- Order Limits
- Class 1 - Compulsory acquisition of land
- Class 2 - Compulsory acquisition of rights - Overhead line
- Class 3 - Compulsory acquisition of rights - Underground cable system
- Class 4 - Compulsory acquisition of rights - Overhead line and underground cable system
- Class 5 - Compulsory acquisition of rights - Access
- Class 6 - Compulsory acquisition of rights - Drainage
- Class 7 - Temporary use
- Class 8 - Land not subject to powers of acquisition nor temporary use

Notes

- For additional detail on the plan suites, please refer to the Guide to Plans (document reference 2.0), located in the Volume 2 of the DCO application.
- This drawing is scaled at paper size A0, therefore any prints taken at smaller sizes will affect accuracy of the measurement units and should not be scaled against.

Coordinate System: British National Grid
Sheet X Centroid Coordinate : 604241 Sheet Y Centroid Coordinate : 226287

0 50 100 150 200 250 Metres

BACKGROUND MAPPING INFORMATION HAS BEEN REPRODUCED FROM THE ORDNANCE SURVEY BY PERMISSION OF ORDNANCE SURVEY OF THE CONTROLLER OF HIS MAJESTY'S STATIONERY OFFICE. © CROWN COPYRIGHT AND DATABASE RIGHTS (2025) LICENCE OS100024241 AND AC0000807946.

B	OCT-2025	October 2025 Update	CBE	AMI	CLJ
A	AUG-2025	For DCO submission	CBE	AMI	CLJ

Issue	Date	Remarks	Drawn	Checked	Approved
-------	------	---------	-------	---------	----------

Title:
THE NATIONAL GRID
(NORWICH TO TILBURY) ORDER
LAND PLANS
REGULATION 5(2)(i)-(iii)
SECTION C (SHEET 17 OF 18
COLCHESTER CITY COUNCIL
AND TENDRING DISTRICT COUNCIL)

nationalgrid

PINS Application Number
EN020027

National Grid Drawing Reference
AENC-TOST-LAN-DWG-0002

Scale	Sheet Size	Sheet	Issue
1:2,500	A0	SHEET 17 of 18	B

FOR CONTINUATION SEE SHEET 18

FOR CONTINUATION SEE SHEET 12

FOR CONTINUATION SEE SHEET 13

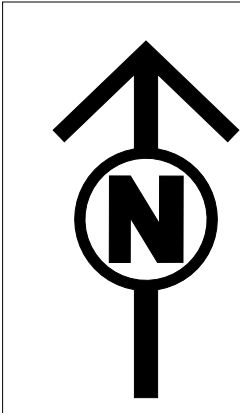

THE NATIONAL GRID (NORWICH TO TILBURY) ORDER
LAND PLANS
REGULATION 5(2)(i)-(iii)
SECTION C (SHEET 18 OF 18,
COLCHESTER CITY COUNCIL AND TENDRING DISTRICT COUNCIL)

Application Document 2.2

SITE MAP

C

Legend

- Local authority boundary
- Section boundary & local authority boundary
- Section boundary
- Sheet index cutlines
- Order Limits
- Class 1 - Compulsory acquisition of land
- Class 2 - Compulsory acquisition of rights - Overhead line
- Class 3 - Compulsory acquisition of rights - Underground cable system
- Class 4 - Compulsory acquisition of rights - Overhead line and underground cable system
- Class 5 - Compulsory acquisition of rights - Access
- Class 6 - Compulsory acquisition of rights - Drainage
- Class 7 - Temporary use
- Class 8 - Land not subject to powers of acquisition nor temporary use

Notes

- For additional detail on the plan suites, please refer to the Guide to Plans (document reference 2.0), located in the Volume 2 of the DCO application.
- This drawing is scaled at paper size A0, therefore any prints taken at smaller sizes will affect accuracy of the measurement units and should not be scaled against.

Coordinate System: British National Grid
Sheet X Centroid Coordinate : 602701 Sheet Y Centroid Coordinate : 229778



BACKGROUND MAPPING INFORMATION HAS BEEN REPRODUCED FROM THE ORDNANCE SURVEY BY PERMISSION OF ORDNANCE SURVEY OF THE CONTROLLER OF HIS MAJESTY'S STATIONERY OFFICE. © CROWN COPYRIGHT AND DATABASE RIGHTS (2025) LICENCE OS100024241 AND AC0000807346.

B	OCT-2025	October 2025 Update	CBE	AMI	CLJ
A	AUG-2025	For DCO submission	CBE	AMI	CLJ

Issue	Date	Remarks	Drawn	Checked	Approved
-------	------	---------	-------	---------	----------

Title:
THE NATIONAL GRID
(NORWICH TO TILBURY) ORDER
LAND PLANS
REGULATION 5(2)(i)-(iii)
SECTION C (SHEET 18 OF 18
COLCHESTER CITY COUNCIL
AND TENDRING DISTRICT COUNCIL)

nationalgrid

PINS Application Number
EN020027

National Grid Drawing Reference
AENC-TQST-LAN-DWG-0002

Scale	Sheet Size	Sheet	Issue
1:2,500	A0	SHEET 18 of 18	B